

Anyone wishing to attend will need to call ahead at 913-684-0417 to reserve a seat as the meeting room has limited capacity. We are encouraging everyone to continue to view the meeting live via YouTube.

***Leavenworth County  
Board of County Commissioners***

***Regular Meeting Agenda***  
300 Walnut Street, Suite 225  
Leavenworth, KS 66048  
January 19, 2022  
9:00 a.m.

- I. CALL TO ORDER
- II. PLEDGE OF ALLEGIANCE/MOMENT OF SILENCE
- III. ROLL CALL
- IV. PUBLIC COMMENT: Public Comment shall be limited to 15 minutes at the beginning of each meeting for agenda items **only** and limited to three minutes per person. Comments at the end of the meeting shall be open to any topic of general interest to the Board of County Commissioners and limited to five minutes per person. There should be no expectation of interaction by the Commission during this time.  
  
Anyone wishing to make comments either on items on the agenda or not are encouraged to provide their comments in writing no later than 8:00 AM the Monday immediately preceding the meeting. These comments will be included in the agenda packet for everyone to access and review. This allows the Commission to have time to fully consider input and request follow up if needed prior to the meeting.
- V. ADMINISTRATIVE BUSINESS:
  - a) Appointment of Non-Lawyer Member to the Judicial Nominating Commission
- VI. CONSENT AGENDA: The items on the Consent Agenda are considered by staff to be routine business items. Approval of the items may be made by a single motion, seconded, and a majority vote with no separate discussion of any item listed. Should a

member of the Governing Body desire to discuss any item, it will be removed from the Consent Agenda and considered separately.

- a) Approval of the minutes of January 12, 2022
- b) Approval of the schedule for the week January 24, 2022
- c) Approval of the check register
- d) Approve and sign the OCB's

**VII. FORMAL BOARD ACTION:**

- a) Consider a motion to approve an agreement for services with the Guidance Center.
- b) Consider a motion to accept low bid from Linaweaver Construction for the 158<sup>th</sup> Street improvement project in the amount of \$3,125,000.00.

**VIII. PRESENTATIONS AND DISCUSSION ITEMS:** presentations are materials of general concern where no action or vote is requested or anticipated.

- a) Quarterly Reports
  - Solid Waste
  - Public Works
- b) Executive session to discuss non-elected personnel
- c) Executive session to discuss security

**IX. ADDITIONAL PUBLIC COMMENT IF NEEDED**

**ADJOURNMENT**



# The Supreme Court of Kansas

Douglas T. Shima, *Clerk*  
Michelle R. Moore  
*Judicial Conduct Administrator*

KANSAS JUDICIAL CENTER  
301 SW 10<sup>th</sup> Avenue, Room 115  
Topeka, Kansas 66612-1507

Telephone 785-296-2913  
Facsimile 785-296-1028  
[jdnc@kscourts.org](mailto:jdnc@kscourts.org)

January 11, 2022

Janet Klasinski  
Leavenworth County Clerk  
[jklasinski@leavenworthcounty.gov](mailto:jklasinski@leavenworthcounty.gov)

Re: Appointment of Non-Lawyer Members to the Judicial Nominating Commission

Dear Ms. Klasinski:

The term(s) of office for the following non-lawyer member(s) of the 1st District Judicial Nominating Commission will expire the first Monday in March 2022.

MARK D. PREISINGER

In accordance with the provisions of K.S.A. 20-2905(b), it will be necessary for a member of your Board of County Commissioners to appoint someone to fill the vacancy created.

The member who is presently serving may be reappointed, or you may make a new appointment. The term of office for the new appointment will be from March 7, 2022, to March 2, 2026.

As soon as the appointment is made, but no later than February 15, 2022, please notify this office of the **full name, address, telephone numbers** (both home and work), and **email address** of the person you have appointed.

Cordially,

A handwritten signature in black ink that reads "Douglas T. Shima".

Douglas T. Shima  
Clerk of the Supreme Court

mm

\*\*\*\*\*January 12, 2022\*\*\*\*\*

The Board of County Commissioners met in a regular session on Wednesday, January 12, 2022. Commissioner Mike Smith, Commissioner Culbertson, Commissioner Kaaz, Commissioner Doug Smith and Commissioner Stieben are present; Also present: Mark Loughry, County Administrator; David Van Parys, Senior County Counselor; Janet Klasinski, County Clerk; Connie Harmon, Council on Aging Director; Krystal Voth, Planning and Zoning Director; Larry Malbrough, Information Systems Director; Janice Van Parys, County Treasurer; Dave Arteberry with Stifel, Nicolaus and Co.; John Richmeier, Leavenworth Times

Residents: AW Himpel, Joe Herring, John Matthews, Dennis Taylor

**PUBLIC COMMENT:**

There were no public comments.

**ADMINISTRATIVE BUSINESS:**

*A motion was made by Commissioner Culbertson and seconded by Commissioner Doug Smith to accept the consent agenda for Wednesday, January 12, 2022 as presented.*

*Motion passed, 5-0.*

*A motion was made by Commissioner Doug Smith and seconded by Commissioner Stieben to adjourn sine die.*

*Motion passed, 5-0.*

*A motion was made by Commissioner Stieben and seconded by Commissioner Culbertson to appoint Mike Smith as temporary chair.*

*Motion passed, 5-0.*

*A motion was made by Commissioner Doug Smith and seconded by Commissioner Mike Smith to return to regular session.*

*Motion passed, 5-0.*

*A motion was made by Commissioner Stieben and seconded by Commissioner Culbertson to appoint Mike Smith as chairperson.*

*Motion passed, 5-0.*

*A motion was made by Commissioner Doug Smith and seconded by Commissioner Mike Smith to keep Wednesday as the regular meeting day.*

*Motion passed, 5-0.*

*A motion was made by Commissioner Stieben and seconded by Commissioner Mike Smith to designate the Leavenworth Times as the official newspaper for the County.*

*Motion passed, 5-0.*

Janet Klasinski reported she would like to extend the agreement with Commerce Bank as the depository for the County.

*A motion was made by Commissioner Doug Smith and seconded by Commissioner Culbertson to keep Commerce Bank as the official depository for Leavenworth County.*

*Motion passed, 5-0.*

*A motion was made by Commissioner Doug Smith and seconded by Commissioner Mike Smith to approve Resolution 2022-2, setting the Elected Officials salaries as approved in the 2022 budget.*

Commissioner Culbertson mentioned compensation for the County Clerk for her duties as the Human Resources Director.

It was the consensus of the Board to have the County Administrator get a stipend amount and present it to the Board.

*Motion passed, 5-0.*

Dave Arteberry presented Resolution 2022-3, the issuance of general obligation sales tax bonds.

*A motion was made by Commissioner Doug Smith and seconded by Commissioner Culbertson to approve Resolution 2022-3, the issuance of general obligation sales tax bonds.*

*Motion passed, 5-0.*

Larry Malbrough requested approval of an agreement with iBoss for web filtering solutions for Leavenworth County.

*A motion was made by Commissioner Culbertson and seconded by Commissioner Mike Smith to authorize the chairman to sign a three- year renewal contract with iBoss for the County's web filtering solutions in the amount of \$13,655.56.*

*Motion passed, 5-0.*

Todd Thompson requested funding from the ARPA funds for additional personnel.

*A motion was made by Commissioner Stieben and seconded by Commissioner Culbertson to approve the request from the County Attorney's Office for \$250,000.00 for one year on the condition that he meets with Mr. Loughry to review budget processes and potential other areas to find the money.*

*Motion passed, 5-0.*

Connie Harmon presented the quarterly report for Council on Aging.

Krystal Voth presented the quarterly report for Planning and Zoning.

No executive session was held.

Commissioner Mike Smith attended the Lansing City Council meeting and the Fire District #1 meeting.

Commissioner Doug Smith will attend the Basehor City Council meeting this evening.

Commissioner Stieben reported that individuals from the Trinity Lutheran Church will be participating in further tornado clean up in the area of 166<sup>th</sup> and Stilwell.

Commissioner Culbertson met with Senator Jeff Pittman and attended the Leavenworth City Commission meeting.

Commissioner Mike Smith met with Commissioner Jermaine Wilson and Bill Noll to discuss the 152 bridge.

Commissioner Kaaz also attended the Fire District #1 meeting, the Mental Health Task Force meeting and a fundraiser for the Leavenworth School Foundation.

*A motion was made by Commissioner Doug Smith and seconded by Commissioner Kaaz to adjourn.  
Motion passed, 5-0.*

The Board adjourned at 10:10 a.m.

Draft

# LEAVENWORTH COUNTY COMMISSIONERS MEETING SCHEDULE

Monday, January 24, 2022

Tuesday, January 25, 2022

Wednesday, January 26, 2022

9:00 a.m.      Leavenworth County Commission meeting  
• Commission Meeting Room, 300 Walnut, Leavenworth KS

Thursday, January 27, 2022

Friday, January 28, 2022

ALL SUCH OTHER BUSINESS THAT MAY COME BEFORE THE COMMISSION

ALL MEETINGS ARE OPEN TO THE PUBLIC

COMMENTS SHOULD BE OF GENERAL INTEREST OF THE PUBLIC AND SUBJECT TO THE RULES OF DECORUM

START DATE: 01/08/2022 END DATE: 01/14/2022

TYPES OF CHECKS SELECTED: \* ALL TYPES

			P.O.NUMBER	CHECK#					
1054	ALLIANCE A	ALLIANCE AGAINST FAMILY VIOLEN	325137	96422 AP	01/14/2022	2-001-5-29-204	PER LVCO 2022 BUDGET	13,750.00	
22369	BAMFORD FI	BAMFORD FIRE SPRINKLER	325138	96423 AP	01/14/2022	2-001-5-32-266	QUARTERLY INSPECTION JUSTICE C	655.00	
2771	BOYD SHAWN APPEALS	SHAWN BOYD	325140	96425 AP	01/14/2022	2-001-5-11-240	APPEAL 2021-CR-00026	600.00	
1065	BTX	BTX KS, INC	325141	96426 AP	01/14/2022	2-001-5-07-219	INMATE X-RAY	78.00	
25101	CANON U S	CANON U S A INC	325142	96427 AP	01/14/2022	2-001-5-19-204	1865950 COPIER CLICKS-CLERKS F	223.41	
1639	CDWAK	COUNTY WEED DIRECTORS ASSN	325144	96429 AP	01/14/2022	2-001-5-53-203	84TH ANNUAL CONF	300.00	
1639	CDWAK	COUNTY WEED DIRECTORS ASSN	325144	96429 AP	01/14/2022	2-001-5-53-203	84TH ANNUAL CONF	60.00	
1639	CDWAK	COUNTY WEED DIRECTORS ASSN	325144	96429 AP	01/14/2022	2-001-5-53-203	84TH ANNUAL CONF	75.00	
1639	CDWAK	COUNTY WEED DIRECTORS ASSN	325144	96429 AP	01/14/2022	2-001-5-53-203	84TH ANNUAL CONF	105.00	
							*** VENDOR	1639 TOTAL	540.00
2395	CMH PROFESSIONAL GRO	CMH PROFESSIONAL GROUP	325145	96430 AP	01/14/2022	2-001-5-14-321	EVIDENCE COLLECTION	725.00	
2395	CMH PROFESSIONAL GRO	CMH PROFESSIONAL GROUP	325145	96430 AP	01/14/2022	2-001-5-14-321	EVIDENCE COLLECTION	725.00	
2395	CMH PROFESSIONAL GRO	CMH PROFESSIONAL GROUP	325145	96430 AP	01/14/2022	2-001-5-14-321	EVIDENCE COLLECTION	725.00	
2395	CMH PROFESSIONAL GRO	CMH PROFESSIONAL GROUP	325145	96430 AP	01/14/2022	2-001-5-14-321	EVIDENCE COLLECTION	725.00	
							*** VENDOR	2395 TOTAL	2,900.00
11721	DEAF EXPRESSION, INC	DEAF EXPRESSION, INC	325148	96433 AP	01/14/2022	2-001-5-19-221	INTERPRETER 1/5/22	189.80	
1219	DIST CT CLERK LV	CLERK OF DIST COURT-LEAV	325149	96434 AP	01/14/2022	2-001-5-11-501	COURT COSTS (LVCO ATTORNEY)	3,394.00	
86	EVERGY	EVERGY KANSAS CENTRAL INC	325136	96421 AP	01/13/2022	2-001-5-07-223	ELEC SVC TO SIRENS	1,101.58	
134	EXEQTIME SYSTEMS	EXEQTIME SYSTEMS	325151	96436 AP	01/14/2022	2-001-5-19-301	INK RIBBON FOR TIME STAMPS (CL	224.15	
5824	FRONTIER	FORENSIC MEDICAL HOLDINGS OF K	325152	96437 AP	01/14/2022	2-001-5-11-213	2021CR541 WITNESS TESTIMONY	400.00	
22605	HINCKLEY S	HINCKLEY SPRINGS	325153	96438 AP	01/14/2022	2-001-5-11-208	17137512660768 FILTRATION SYST	42.50	
552	HUTTON, ASHLEY	ASHLEY HUTTON	325154	96439 AP	01/14/2022	2-001-5-11-240	APPEAL 2019JC58	600.00	
236	INTERPRETERS	INTERPRETERS INC	325155	96440 AP	01/14/2022	2-001-5-19-221	INTERPRETER 1/3/22 2021CR751	159.20	
4180	KDJA	KANSAS DIST JUDGES' ASSOC C/O	325158	96443 AP	01/14/2022	2-001-5-19-203	2022 DUES	100.00	
4180	KDJA	KANSAS DIST JUDGES' ASSOC C/O	325158	96443 AP	01/14/2022	2-001-5-19-203	2022 DUES	100.00	
4180	KDJA	KANSAS DIST JUDGES' ASSOC C/O	325158	96443 AP	01/14/2022	2-001-5-19-203	2022 DUES	100.00	
4180	KDJA	KANSAS DIST JUDGES' ASSOC C/O	325158	96443 AP	01/14/2022	2-001-5-19-203	2022 DUES	100.00	
							*** VENDOR	4180 TOTAL	400.00
4755	LEAV PAPER	LEAVENWORTH PAPER AND OFFICE S	325161	96446 AP	01/14/2022	2-001-5-11-301	CO ATTY - 1 SKID (40 BOXES) PA	1,640.00	
4755	LEAV PAPER	LEAVENWORTH PAPER AND OFFICE S	325161	96446 AP	01/14/2022	2-001-5-19-301	DIST CT CSO OFFICE SUPPLIES	1,026.66	
4755	LEAV PAPER	LEAVENWORTH PAPER AND OFFICE S	325161	96446 AP	01/14/2022	2-001-5-19-301	DIST CT CLERK OFFICE SUPPLIES	1,222.41	
4755	LEAV PAPER	LEAVENWORTH PAPER AND OFFICE S	325161	96446 AP	01/14/2022	2-001-5-19-301	DIST CT CLEKR - FOAM CUPS	12.60	
							*** VENDOR	4755 TOTAL	3,901.67
1693	LEAV ROTARY	LEAVENWORTH ROTARY CLUB #1621	325162	96447 AP	01/14/2022	2-001-5-11-203	DUES/MEMBERSHIP - TODD THOMPSON	171.50	
537	LEAV TIMES	LEAVENWORTH TIMES	325163	96448 AP	01/14/2022	2-001-5-09-233	1931 PUBLICATION OF BACK TAXES	74.25	
17677	LEXISNEXIS RISK DATA	LEXISNEXIS RISK DATA MGMT (ACC	325164	96449 AP	01/14/2022	2-001-5-09-203	1314401 DECEMBER MINIMUM COMMI	50.00	
2201	LINEAGE	AVCORP BUSINESS SYSTEMS LLC	325165	96450 AP	01/14/2022	2-001-5-14-235	LEA008 1 YEAR MAINT TO 2.3.23	1,353.60	
17197	MIAMI CO A	MIAMI COUNTY ATTORNEY	325166	96451 AP	01/14/2022	2-001-5-19-222	REVIEW 12/16/2021-2021CT083	50.00	
28640	MID-CONTIN	MID-CONTINENT MICROGRAPHICS	325167	96452 AP	01/14/2022	2-001-5-14-227	C2268 ANNUAL STORAGE MAINTENAN	66.50	
2962	MOTOROLA SOLUTIONS	MOTOROLA SOLUTIONS CREDIT CO	325169	96454 AP	01/14/2022	2-001-5-14-2	100301747 SYSTEM UPGRADES - TO	107,560.92	
7926	PAWNEE	CLERK OF DISTRICT COURT - PAWN	325171	96456 AP	01/14/2022	2-001-5-19-222	ATTORNEY FEES 2021CT260	190.00	
103	RESTITUTIO								
							*** VENDOR	103 TOTAL	812.00
458	ROAD & BRIDGE	LEAV CO PUBLIC WORKS	325177	96462 AP	01/14/2022	2-001-5-07-213	VLSO FUEL, VEH MAINT	447.47	
458	ROAD & BRIDGE	LEAV CO PUBLIC WORKS	325177	96462 AP	01/14/2022	2-001-5-07-213	VLSO FUEL, VEH MAINT	69.35	
458	ROAD & BRIDGE	LEAV CO PUBLIC WORKS	325177	96462 AP	01/14/2022	2-001-5-14-332	VLSO FUEL, VEH MAINT	21.44	
							*** VENDOR	458 TOTAL	538.26
22374	RVI	REAL VISION SOFTWARE INC	325178	96463 AP	01/14/2022	2-001-5-18-254	CUST 904 ANNUAL SUPPORT	3,300.00	

warrants by vendor



TYPES OF CHECKS SELECTED: \* ALL TYPES

			P.O.NUMBER	CHECK#					
829	THOMSON REUTERS	THOMSON REUTERS - WEST	325181	96466 AP	01/14/2022	2-001-5-11-210	1000590171 WEST INFORMATION CH	789.85	
41	UNDERGROUN	UNDERGROUND VAULTS & STORAGE	325182	96467 AP	01/14/2022	2-001-5-19-214	100492 FILE RETRIEVAL, PALLET	270.64	
11982	UNIFIED GO	UNIFIED GOVERNMENT OF WYANDOTT	325183	96468 AP	01/14/2022	1-001-5-07-2	LVCO JUVENILES HOUSED FOR 109	16,350.00	
100	WITNESS LIST								
							*** VENDOR	100 TOTAL	173.20
							TOTAL FUND 001		160,910.03
22543	COMPLETE FAMILY CARE	COMPLETE FAMILY CARE	325147	96432 AP	01/14/2022	2-108-5-00-280	HEALTH DEPT JANUARY 2022	1,200.00	
22543	COMPLETE FAMILY CARE	COMPLETE FAMILY CARE	325147	96432 AP	01/14/2022	2-108-5-00-280	HEALTH DEPT JANUARY 2022	300.00	
							*** VENDOR	22543 TOTAL	1,500.00
6605	KS ASSON OF LOCAL HE	KANSAS ASSN OF LOCAL HEALTH DE	325159	96444 AP	01/14/2022	2-108-5-00-203	2022 DUES BASE DUES, POPULAT	510.00	
6605	KS ASSON OF LOCAL HE	KANSAS ASSN OF LOCAL HEALTH DE	325159	96444 AP	01/14/2022	2-108-5-00-203	2022 DUES BASE DUES, POPULAT	822.46	
							*** VENDOR	6605 TOTAL	1,332.46
6539	MTI SECURITY	A&M SECURITY SOLUTIONS INC	325170	96455 AP	01/14/2022	2-108-5-00-219	SECURITY MONITORING TO 3.31.22	60.00	
							TOTAL FUND 108		2,892.46
24545	CDW GOVERN	CDW GOVERNMENT INC	325143	96428 AP	01/14/2022	2-115-5-00-409	3773122 HARDWARE (IS)	107.90	
24545	CDW GOVERN	CDW GOVERNMENT INC	325143	96428 AP	01/14/2022	2-115-5-00-409	3773122 HARDWARE (IS)	23.56	
24545	CDW GOVERN	CDW GOVERNMENT INC	325143	96428 AP	01/14/2022	2-115-5-00-409	3773122 HARDWARE (IS)	329.50	
							*** VENDOR	24545 TOTAL	460.96
385	CNH INDUSTRIAL	CNH INDUSTRIAL CAPITAL AMERICA	325146	96431 AP	01/14/2022	2-115-5-00-418	CUST 2223213 12 MONTHS LEASE 3	3,478.38	
385	CNH INDUSTRIAL	CNH INDUSTRIAL CAPITAL AMERICA	325146	96431 AP	01/14/2022	2-115-5-00-418	CUST 2223213 12 MONTHS LEASE 3	3,478.38	
385	CNH INDUSTRIAL	CNH INDUSTRIAL CAPITAL AMERICA	325146	96431 AP	01/14/2022	2-115-5-00-418	CUST 2223213 12 MONTHS LEASE 3	3,478.38	
385	CNH INDUSTRIAL	CNH INDUSTRIAL CAPITAL AMERICA	325146	96431 AP	01/14/2022	2-115-5-00-418	CUST 2223213 12 MONTHS LEASE 3	3,478.38	
385	CNH INDUSTRIAL	CNH INDUSTRIAL CAPITAL AMERICA	325146	96431 AP	01/14/2022	2-115-5-00-418	CUST 2223213 12 MONTHS LEASE 3	3,478.38	
385	CNH INDUSTRIAL	CNH INDUSTRIAL CAPITAL AMERICA	325146	96431 AP	01/14/2022	2-115-5-00-418	CUST 2223213 12 MONTHS LEASE 3	3,478.38	
385	CNH INDUSTRIAL	CNH INDUSTRIAL CAPITAL AMERICA	325146	96431 AP	01/14/2022	2-115-5-00-418	CUST 2223213 12 MONTHS LEASE 3	3,478.38	
385	CNH INDUSTRIAL	CNH INDUSTRIAL CAPITAL AMERICA	325146	96431 AP	01/14/2022	2-115-5-00-418	CUST 2223213 12 MONTHS LEASE 3	3,478.38	
385	CNH INDUSTRIAL	CNH INDUSTRIAL CAPITAL AMERICA	325146	96431 AP	01/14/2022	2-115-5-00-418	CUST 2223213 12 MONTHS LEASE 3	3,478.38	
385	CNH INDUSTRIAL	CNH INDUSTRIAL CAPITAL AMERICA	325146	96431 AP	01/14/2022	2-115-5-00-418	CUST 2223213 12 MONTHS LEASE 3	3,478.38	
385	CNH INDUSTRIAL	CNH INDUSTRIAL CAPITAL AMERICA	325146	96431 AP	01/14/2022	2-115-5-00-418	CUST 2223213 12 MONTHS LEASE 3	3,478.38	
385	CNH INDUSTRIAL	CNH INDUSTRIAL CAPITAL AMERICA	325146	96431 AP	01/14/2022	2-115-5-00-418	CUST 2223213 12 MONTHS LEASE 3	3,478.38	
385	CNH INDUSTRIAL	CNH INDUSTRIAL CAPITAL AMERICA	325146	96431 AP	01/14/2022	2-115-5-00-418	CUST 2223213 12 MONTHS LEASE 3	3,478.38	
							*** VENDOR	385 TOTAL	41,740.56
							TOTAL FUND 115		42,201.52
28640	MID-CONTIN	MID-CONTINENT MICROGRAPHICS	325167	96452 AP	01/14/2022	2-119-5-00-252	C2258 ANNUAL STORAGE,MAINT TO	65.00	
28640	MID-CONTIN	MID-CONTINENT MICROGRAPHICS	325167	96452 AP	01/14/2022	2-119-5-00-252	C2258 ANNUAL STORAGE,MAINT TO	27.75	
28640	MID-CONTIN	MID-CONTINENT MICROGRAPHICS	325167	96452 AP	01/14/2022	2-119-5-00-252	C2258 ANNUAL STORAGE,MAINT TO	520.50	
							*** VENDOR	28640 TOTAL	613.25
							TOTAL FUND 119		613.25
2666	MISC REIMBURSEMENTS	BIL NOLL	325168	96453 AP	01/14/2022	2-133-5-00-201	1-4 REIM MILEAGE - 2022 SALINA	186.62	
632	RWD 8	RURAL WATER DIST NO 8	325179	96464 AP	01/14/2022	2-133-5-00-214	1-2 WATER SVC 2 WATER METERS A	102.12	
632	RWD 8	RURAL WATER DIST NO 8	325179	96464 AP	01/14/2022	2-133-5-00-214	1-2 WATER SVC 2 WATER METERS A	162.00	
							*** VENDOR	632 TOTAL	264.12

warrants by vendor

TYPES OF CHECKS SELECTED: \* ALL TYPES

			P.O.NUMBER	CHECK#					
2650	SHERMAN TOWNSHIP	SHERMAN TOWNSHIP	325180	96465 AP	01/14/2022	2-133-5-00-209	1-3 YEAR 10 OF 10 LEASE FOR SA	1,000.00	
							TOTAL FUND 133		1,450.74
446	EQUIPMENT SHARE	EQUIPMENT SHARE INC	325150	96435 AP	01/14/2022	2-160-5-00-213	TRANSFER STATION - STEEL PIPE	167.00	
9271	LANSING CI	CITY OF LANSING	325160	96445 AP	01/14/2022	2-160-5-00-210	TRANSFER STA. SEWER GILW-136	41.70	
							TOTAL FUND 160		208.70
29034	MHS	MCAFEE HENDERSON SOLUTIONS	325132	1613 AP	01/13/2022	2-171-5-05-201	1-2 HRRR PROJ 2021.046.001 KDO	19,922.76	
2018	STANDARD & POOR'S	STANDARD & POOR'S	325133	1614 AP	01/13/2022	2-171-5-00-401	CUST 1000112457 SVCS RENDERED	15,750.00	
							TOTAL FUND 171		35,672.76
24445	JOHNSON CO	JOHNSON CO GOVERNMENT	325156	96441 AP	01/14/2022	2-210-5-00-3	SEWER DIST - VARIOUS TEST	236.50	
1851	KANSAS ONE-CALL SYST	KANSAS ONE-CALL SYSTEM INC	325157	96442 AP	01/14/2022	2-210-5-00-2	08-LVPWD01 LOCATES	3.60	
							TOTAL FUND 210		240.10
24445	JOHNSON CO	JOHNSON CO GOVERNMENT	325156	96441 AP	01/14/2022	2-212-5-00-3	SEWER DIST - VARIOUS TEST	236.50	
1851	KANSAS ONE-CALL SYST	KANSAS ONE-CALL SYSTEM INC	325157	96442 AP	01/14/2022	2-212-5-00-2	08-LVPWD01 LOCATES	3.60	
							TOTAL FUND 212		240.10
24445	JOHNSON CO	JOHNSON CO GOVERNMENT	325156	96441 AP	01/14/2022	2-218-5-00-3	SEWER DIST - VARIOUS TEST	236.50	
							TOTAL FUND 218		236.50
2570	BOND ESCROW REFUND	BRIAN AND RENEE PORTER	325139	96424 AP	01/14/2022	2-503-5-00-2	1-1 REFUND ENTRANCE PERMIT ST	100.00	
							TOTAL FUND 503		100.00
							TOTAL ALL CHECKS		244,766.16

TYPES OF CHECKS SELECTED: \* ALL TYPES

FUND SUMMARY

001	GENERAL	160,910.03
108	COUNTY HEALTH	2,892.46
115	EQUIPMENT RESERVE	42,201.52
119	ROD TECHNOLOGY	613.25
133	ROAD & BRIDGE	1,450.74
160	SOLID WASTE MANAGEMENT	208.70
171	S TAX CAP RD PROJ: 2015 SERIES	35,672.76
210	SEWER DISTRICT 1: HIGH CREST	240.10
212	SEWER DISTRICT 2: TIMBERLAKES	240.10
218	SEWER DIST #5	236.50
503	ROAD & BRIDGE BOND ESCROW	100.00
	TOTAL ALL FUNDS	244,766.16

**Consent Agenda 1/19/2021**  
**Checks dated 1/8-1/14**



The Guidance Center and Leavenworth County Commission

AGREEMENT for Services

This Agreement made and entered into this \_\_\_\_ day of \_\_\_\_\_, 2022, by and between the Board of County Commissioners of Leavenworth County, Kansas (County) and The Guidance Center, Inc., a non-profit corporation (Center), WITNESSETH:

As a consideration of mutual covenants and agreement here contained for calendar year 2022, it is agreed as follows:

1. Services. The Center will provide the full spectrum of basic CMHC services to all county residents regardless of their ability to pay for services. These services include intake, individual, family, and group psychotherapy services, as well as psychiatric medication management. Services will also include all Community Based Services delivered to Seriously Mentally Ill Adults and Children living within Leavenworth County.
2. Compensation. As compensation for services, the County shall pay to the Center the sum of \$291,237.00 for the calendar year of 2022. Payments shall be drawn at various times throughout the year. County funds are utilized to assist Leavenworth County residents who are uninsured or underinsured to receive services.
3. Financial and Service Reports. The Center will submit financial and service reports to the County at least semi-annually or as requested by the Commission.
4. Communications. It is in the best interest of the public, the County, and the Center that any issues in the performance of this Agreement be defined, communicated, and resolved at the management level for the County and for the Center. If any issue cannot be resolved at the management level, communication between the chairman of the County Commission and the President of the Board of Directors for The Center shall be undertaken to resolve any such concerns.
5. Contract renewal and/or termination. The Center shall submit an annual report and funding request by mid May of each year at which time renewal, modification or termination of this Agreement will be undertaken by the County and the Center.
6. Additional provisions of this Agreement. As a result of this Agreement, the By Laws of the Center allow for County Commissioners to confirm the appointment of two Leavenworth County Board members. As County appointed positions are vacated, the Center Board will submit names for possible appointment. Commissioners can accept the nominee or ask for additional candidate names.
7. Indemnity/Hold Harmless. The Center Shall hold the County harmless from and indemnify the County for any loss sustained by the County as a result of the conduct of the Center.

\_\_\_\_\_  
Keith Rickard, Executive Director  
The Guidance Center

\_\_\_\_\_  
Leavenworth County Commissioner

\_\_\_\_\_  
Leavenworth County Commissioner

\_\_\_\_\_  
Leavenworth County Commissioner  
Chairman

# Leavenworth County Request for Board Action

Date: January 13, 2022  
To: Board of County Commissioners  
From: Public Works  
Department Head Approval: B. Noll

## Additional Reviews as needed:

Budget Review  Administrator Review  Legal Review

---

---

**Action Requested:** Accept the low bid for the County Route 2 (158<sup>th</sup> Street) Improvement project.

**Recommendation:** Approve the low bid for construction.

### Analysis:

Inflation has occurred at such a rate that 3<sup>rd</sup> Quarter 2021 bid tab numbers were already low. Within the low bidders bid tab the cost difference primarily was seen in the culvert costs. I based the amount for the contingency fee on the fact that the plans were only updated and the vast majority of the plans were developed after a 2003 field survey. K

We have to pay for the project in full and KDOT will reimburse the county \$900,000 for the Cost Share Grant received.

Bids were solicited in accordance with the Leavenworth County and KDOT Policy and read aloud publicly at 10:00am on January 13, 2022. Public Works received 7 bids with Linaweaver submitting the low bid. Results are included in the attached document with the totals shown below:

Engineer's Estimate - Prepared by MHS	\$2,900,488.15
Linaweaver Construction - Lansing, KS - Leavenworth County	\$2,995,505.50
JM Fahey Construction Company - Grandview, MO	\$3,689,716.00
Bettis Asphalt & Company - Topeka, KS - Shawnee County	\$3,590,091.20
Miles Excavating - Basehor, KS - Leavenworth County	\$4,742,260.92
VF Anderson Builders - Harrisonville, MO	\$3,125,822.89
Leavenworth Excavating & Equip. - Leavenworth, KS - Leavenworth County	\$3,412,597.60
Amino Brothers - Kansas City - Wyandotte County, KS	\$3,805,769.40

Both the low bid and the local bid, from Linaweaver Construction, located in Lansing, KS, is \$2,995,505.50.

Contract =	\$2,995,505.50
~4% Contingency =	\$129,494.50
Total Amount Requested =	\$3,125,000

**Alternatives:** Table, Deny, Approve

### Budgetary Impact:

- Not Applicable  
 Budgeted item with available funds – 171 Sales Tax

- Non-Budgeted item with available funds through prioritization
- Non-Budgeted item with additional funds requested

**Total Amount Requested:**

Contract approval amount not to exceed \$3,125,000

**Additional Attachments:**

2022.01.13 Final Bid Tabulation



**COUNTY OF LEAVENWORTH**  
 COUNTY ROUTE 2 (158TH STREET) IMPROVEMENTS BID OPENING (01/13/2022)  
 BID TABULATION - FINAL

ITEM NO.	Item Description	Unit	Quantity	Engineer's Estimate Prepared by MHS		Linaweaver Construction Lansing, KS - Leavenworth County		JM Fahey Construction Company Grandview, MO		Bettis Asphalt & Company Topeka, KS - Shawnee County		Miles Excavating Basehor, KS - Leavenworth County		VF Anderson Builders Harrisonville, MO		Leavenworth Excavating & Equip. Leavenworth, KS - Leavenworth County		Amino Brothers Kansas City - Wyandotte County, KS		Avg. Unit Price
				Unit Price	Total Cost	Unit Price	Total Cost	Unit Price	Total Cost	Unit Price	Total Cost	Unit Price	Total Cost	Unit Price	Total Cost	Unit Price	Total Cost	Unit Price	Total Cost	
73	6" SDR21 Class 200 RJ PVC Pipe	LF	429	\$ 25.00	\$10,725.00	\$42.00	\$18,018.00	\$100.00	\$42,900.00	\$98.00	\$42,042.00	\$63.08	\$27,061.32	\$55.00	\$23,595.00	\$64.95	\$27,863.55	\$44.40	\$19,047.60	\$70.51
74	16" Steel Casing Pipe (Bored Installation)	LF	60	\$ 180.00	\$10,800.00	\$325.00	\$19,500.00	\$470.00	\$28,200.00	\$455.00	\$27,300.00	\$311.14	\$18,668.40	\$383.00	\$22,980.00	\$345.00	\$20,700.00	\$345.00	\$20,700.00	\$381.52
75	12" Steel Casing Pipe (Bored Installation)	LF	60	\$ 150.00	\$9,000.00	\$290.00	\$17,400.00	\$425.00	\$25,500.00	\$412.00	\$24,720.00	\$311.14	\$18,668.40	\$350.00	\$21,000.00	\$345.00	\$20,700.00	\$309.00	\$18,540.00	\$355.52
76	12" Steel Casing Pipe (Open Cut Installation)	LF	60	\$ 150.00	\$9,000.00	\$154.00	\$9,240.00	\$445.00	\$26,700.00	\$430.00	\$25,800.00	\$132.11	\$7,926.60	\$200.00	\$12,000.00	\$160.00	\$9,600.00	\$164.00	\$9,840.00	\$253.52
77	8" Gate Valve	EA	1	\$ 1,500.00	\$1,500.00	\$2,285.00	\$2,285.00	\$2,300.00	\$2,300.00	\$2,250.00	\$2,250.00	\$1,944.76	\$1,944.76	\$2,200.00	\$2,200.00	\$1,895.00	\$1,895.00	\$2,425.00	\$2,425.00	\$2,145.79
78	6" Gate Valve	EA	9	\$ 1,200.00	\$10,800.00	\$1,550.00	\$13,950.00	\$1,700.00	\$15,300.00	\$1,650.00	\$14,850.00	\$1,382.11	\$12,438.99	\$1,600.00	\$14,400.00	\$1,365.00	\$12,285.00	\$1,723.00	\$15,507.00	\$1,541.19
79	Horizontal Bend - 8"	EA	1	\$ 750.00	\$750.00	\$495.00	\$495.00	\$875.00	\$875.00	\$850.00	\$850.00	\$671.65	\$671.65	\$1,100.00	\$1,100.00	\$815.00	\$815.00	\$526.00	\$526.00	\$801.11
80	Horizontal Bend - 6"	EA	10	\$ 500.00	\$5,000.00	\$620.00	\$6,200.00	\$695.00	\$6,950.00	\$675.00	\$6,750.00	\$871.71	\$8,717.10	\$1,083.00	\$10,830.00	\$690.00	\$6,900.00	\$660.00	\$6,600.00	\$772.45
81	Vertical Bend - 8"	EA	1	\$ 750.00	\$750.00	\$680.00	\$680.00	\$825.00	\$825.00	\$800.00	\$800.00	\$671.65	\$671.65	\$1,100.00	\$1,100.00	\$815.00	\$815.00	\$724.00	\$724.00	\$815.28
82	Vertical Bend - 6"	EA	3	\$ 500.00	\$1,500.00	\$620.00	\$1,860.00	\$770.00	\$2,310.00	\$750.00	\$2,250.00	\$688.24	\$2,064.72	\$1,000.00	\$3,000.00	\$680.00	\$2,040.00	\$660.00	\$1,980.00	\$751.37
83	Fire Hydrant Assembly - STD	EA	3	\$ 4,500.00	\$13,500.00	\$6,000.00	\$18,000.00	\$5,800.00	\$17,400.00	\$5,600.00	\$16,800.00	\$5,304.65	\$15,913.95	\$5,400.00	\$16,200.00	\$6,470.00	\$19,410.00	\$6,409.00	\$19,227.00	\$5,762.44
84	Relocate Existing Fire Hydrant	LS	1	\$ 2,250.00	\$2,250.00	\$1,815.00	\$1,815.00	\$2,500.00	\$2,500.00	\$2,400.00	\$2,400.00	\$3,137.37	\$3,137.37	\$2,000.00	\$2,000.00	\$5,925.00	\$5,925.00	\$1,927.00	\$1,927.00	\$2,962.90
85	Restraint Harness Existing Pipe Joint - 8"	EA	2	\$ 1,200.00	\$2,400.00	\$750.00	\$1,500.00	\$560.00	\$1,120.00	\$550.00	\$1,100.00	\$1,668.96	\$3,337.92	\$300.00	\$600.00	\$350.00	\$700.00	\$800.00	\$1,600.00	\$696.49
86	Restraint Harness Existing Pipe Joint - 6"	EA	11	\$ 1,000.00	\$11,000.00	\$750.00	\$8,250.00	\$510.00	\$5,610.00	\$500.00	\$5,500.00	\$1,658.59	\$18,244.49	\$300.00	\$3,300.00	\$300.00	\$3,300.00	\$724.00	\$7,964.00	\$669.77
87	Marking Post - Std.	EA	4	\$ 55.00	\$220.00	\$132.00	\$528.00	\$1,025.00	\$4,100.00	\$1,000.00	\$4,000.00	\$477.86	\$1,911.44	\$200.00	\$800.00	\$210.00	\$840.00	\$140.00	\$560.00	\$48.89
88	Grounding Anode for Tracer Wire	EA	3	\$ 80.00	\$240.00	\$132.00	\$396.00	\$225.00	\$675.00	\$220.00	\$660.00	\$608.73	\$1,826.19	\$300.00	\$900.00	\$160.00	\$480.00	\$140.00	\$420.00	\$274.29
89	Service Reconnection - 3/4"	EA	1	\$ 800.00	\$800.00	\$550.00	\$550.00	\$3,100.00	\$3,100.00	\$3,000.00	\$3,000.00	\$497.92	\$497.92	\$500.00	\$500.00	\$1,390.00	\$1,390.00	\$584.00	\$584.00	\$1,506.32
90	Service Line - 3/4"	LF	54	\$ 18.00	\$972.00	\$10.00	\$540.00	\$80.00	\$4,320.00	\$75.00	\$4,050.00	\$30.61	\$1,652.94	\$25.00	\$1,350.00	\$72.75	\$3,928.50	\$10.50	\$567.00	\$48.89
91	Connection to Existing 6" Main - 158th St (Sht 48 - A)	LS	1	\$ 3,500.00	\$3,500.00	\$1,650.00	\$1,650.00	\$2,100.00	\$2,100.00	\$2,000.00	\$2,000.00	\$4,754.22	\$4,754.22	\$700.00	\$700.00	\$4,575.00	\$4,575.00	\$1,752.00	\$1,752.00	\$2,629.87
92	Connection to Existing 6" Main - 158th St (Sht 48 - B)	LS	1	\$ 3,500.00	\$3,500.00	\$1,650.00	\$1,650.00	\$2,100.00	\$2,100.00	\$2,000.00	\$2,000.00	\$4,642.21	\$4,642.21	\$1,500.00	\$1,500.00	\$4,545.00	\$4,545.00	\$1,752.00	\$1,752.00	\$2,739.54
93	Connection to Existing 6" Main - 158th St (Sht 48 - C)	LS	1	\$ 3,500.00	\$3,500.00	\$2,200.00	\$2,200.00	\$2,100.00	\$2,100.00	\$2,000.00	\$2,000.00	\$5,093.88	\$5,093.88	\$700.00	\$700.00	\$2,800.00	\$2,800.00	\$2,277.00	\$2,277.00	\$2,482.31
94	Connection to Existing 6" Main - Metro St South Side (Sht 49 - A)	LS	1	\$ 3,500.00	\$3,500.00	\$2,750.00	\$2,750.00	\$2,100.00	\$2,100.00	\$2,000.00	\$2,000.00	\$5,577.19	\$5,577.19	\$1,500.00	\$1,500.00	\$7,955.00	\$7,955.00	\$2,920.00	\$2,920.00	\$3,647.03
95	Connection to Existing 6" Main - Metro St North Side (Sht 49 - A)	LS	1	\$ 3,500.00	\$3,500.00	\$3,300.00	\$3,300.00	\$2,100.00	\$2,100.00	\$2,000.00	\$2,000.00	\$5,577.19	\$5,577.19	\$1,500.00	\$1,500.00	\$2,960.00	\$2,960.00	\$3,504.00	\$3,504.00	\$2,906.20
96	Disconnet Existing 6" Valves - Metro St South Side (Sht 49 - A)	LS	1	\$ 720.00	\$720.00	\$1,100.00	\$1,100.00	\$2,400.00	\$2,400.00	\$2,200.00	\$2,200.00	\$5,577.19	\$5,577.19	\$2,700.00	\$2,700.00	\$1,795.00	\$1,795.00	\$1,168.00	\$1,168.00	\$2,628.70
97	Connection to Existing 6" Main - Honey Creek South Side (Sht 50 - A)	LS	1	\$ 3,500.00	\$3,500.00	\$2,750.00	\$2,750.00	\$2,100.00	\$2,100.00	\$2,000.00	\$2,000.00	\$5,055.51	\$5,055.51	\$700.00	\$700.00	\$5,225.00	\$5,225.00	\$2,920.00	\$2,920.00	\$2,971.75
98	Connection to Existing 6" Main - Honey Creek North Side (Sht 50 - B)	LS	1	\$ 3,500.00	\$3,500.00	\$3,025.00	\$3,025.00	\$2,100.00	\$2,100.00	\$2,000.00	\$2,000.00	\$5,055.51	\$5,055.51	\$700.00	\$700.00	\$8,875.00	\$8,875.00	\$3,212.00	\$3,212.00	\$3,625.92
99	Connection to Existing 8" Main - Honey Creek West Side (Sht 50 - C)	LS	1	\$ 4,500.00	\$4,500.00	\$1,650.00	\$1,650.00	\$2,100.00	\$2,100.00	\$2,000.00	\$2,000.00	\$5,055.51	\$5,055.51	\$1,000.00	\$1,000.00	\$2,865.00	\$2,865.00	\$1,752.00	\$1,752.00	\$2,445.09
<b>BID SUBTOTAL</b>					<b>\$2,900,488.15</b>		<b>\$2,995,505.50</b>		<b>\$3,689,716.00</b>		<b>\$3,590,091.20</b>		<b>\$4,742,260.92</b>		<b>\$3,125,822.89</b>		<b>\$3,412,597.60</b>		<b>\$3,805,769.40</b>	
3% Contingency							\$89,865.17		\$110,691.48		\$107,702.74		\$142,267.83		\$93,774.69		\$102,377.93		\$114,173.08	
<b>TOTAL BOARD APPROVAL</b>							<b>\$3,085,370.67</b>		<b>\$3,800,407.48</b>		<b>\$3,697,793.94</b>		<b>\$4,884,528.75</b>		<b>\$3,219,597.58</b>		<b>\$3,514,975.53</b>		<b>\$3,919,942.48</b>	
Leavenworth County Contractor (local preference, percentage difference from lowest bid)													58.31%				13.92%			



## COUNTY OF LEAVENWORTH SOLID WASTE DEPARTMENT

### Quarterly Report January 19, 2022 - Year End 2021 Totals

#### Tonnage/Materials

---

- 37,034 customers serviced.
- 35,468.44 tons processed.
- 19,685.12 tons of MSW (municipal solid waste).
- 15,007.01 tons of C & D (construction and demolition).
- 4.97 tons of free brush.
- 586.05 tons total brush processed.
- 1378 free tires.
- 78.25 tons total tires processed.

#### Annual Clean-up

---

- 438 Residents – 249.98 tons

#### KDHE

---

- 11/19/21 Annual inspection no violations or citations.
- The annual composting permit is renewed until 12/22/22.
- The annual transfer station permit is renewed until 12/22/22.
- The 2022–5-Year Solid Waste Management Plan Update is due 3/6/2022.
- The annual stormwater permit is renewed until 3/28/22.
- The annual HHW permit is renewed until 6/11/22.

#### HHW

---

- Had 1257 appointments.

#### MEETINGS/TRAINING

---

- Tammy completed CPM class.
- Robbie completed Excel class.
- Staff completed required 8-hour HHW refresher's and new operator has been scheduled to attend.

#### MISCELLANEOUS

---

- Getting close to planning opening of new outbound scale. Outside needs decking, windbreak, shelf and cover for customers and credit card reader to stay out of the elements completed. The display needs set up and the roadway has been cut out. Inside they are working on the final punch list. Computer and network needs installed. Wiring for security system has been installed. Furniture needs placed.



**COUNTY OF LEAVENWORTH**  
DEPARTMENT OF PUBLIC WORKS



## Road and Bridge

Quarterly Report for October 2021-December 2021

\*Aggregate hauled-all types- 20,445.21tons

\*Culvert Replacements:

\* 10 Crossroad Culverts

\* 15 Entrance Culverts

### **Personnel**

\*57 employees within the County Shop and Noxious Weed

\* One Heavy Equipment Operator position that will be filled on 01.19.2022

\* 4 new Heavy Equipment Operators hired within the quarter

## Noxious Weed

There have been significant cost increases for chemicals in the past quarter. The following is the current cost list:

2021 ending chemical prices and changes:

For the following items listed below:

Product	Container size	2021 Bid Price	Final Price	% change
2,4-D Low Vol Ester	2.5 Gal.	12.22	12.22	0 *
2,4-D Amine (4#)	2.5 Gallon	9.27	11.90	28.37 %
Tordon 22K	1 Gallon	39.25	39.25	0
Remedy Ultra	1 Gallon	46.35	46.34	0
Plateau	1 Gallon	94.55	102.50	8.4 %
Glyphosate 41%	2.5 Gallon	12.86	33.00	156.6 %
Pasture Gard HL	1 Gallon	91.58	91.58	0
Terravue	4.4 lbs.	81.60	81.60	0 *
MSO Concentrate	2.5 Gallon	9.40	9.49	1 %
Fusion	2.5 Gallons	148.05	150.00	1 %

\*bought chemical at beginning of the year didn't buy anymore throughout the year

## Projects – See Attached Cost Breakdown of Projects

### 158<sup>th</sup> Street Road Improvement Project – MHS 2004 Design

- Addendums were uploaded to Drexel. This included allowing contractors to utilize fill material excavated from the area the tornado debris was stored. The bid opening was pushed one week to provide adequate time for bidding contractors to review the final two addendums.

- Proposed Schedule:

Advertisement of Construction Bid: 11/22/21



**COUNTY OF LEAVENWORTH**  
DEPARTMENT OF PUBLIC WORKS



Bid Opening: 1/13/22 - Revised  
Late Start Date for Construction: 2/15/21

**K-45 Bridge Replacement Project – Watershed Institute 50/50 grant cost share**

- The upstream on Millwood Road culvert replacement was completed and approved by the WaterShed Institute engineer. This was a replacement of a 114” Culvert.
- Norfolk Crain is now stating they will be starting in the first week of February. FreeState Electric is planning their pole relocation. County survey staff located the Temporary Construction Easements and Right-of-Way for the pole relocations.
- Project Schedule:
  - July 15, 2021 – Early Start Date
  - June 15, 2022 – Final Completion required by date

**Bridge Replacement Designs (A-49, E-18, F-46, T-34) – Benesch**

**These projects are being pushed to completion so that we can build as many as possible with ARPA funds.**

- i. **A-49** – Plans are complete. Right-of-Way and easement exhibits have been mailed to property owners, 2 of 4 have returned signed paperwork. Benesch is identifying utility conflicts and coordinating utility relocation – possible ATT & Atmos conflicts
- ii. **T-34** – Final review completed & provided to Benesch. No Utility status provided. Right-of-Way and easement exhibits have been mailed to property owners, 1/4 have returned signed paperwork. One landowner believes the project will tear out his lateral field. Digger Jim could locate the lateral line in question but did find other lines that are not in conflict. I met with the property owner and took pictures. We will need to be aware of the possible conflict during construction.
- iii. **F-46** – Benesch stated that there are no utility conflicts for this project but had not actually verify the sewer line or the waterline. Staff coordinated with Basehor staff to located the sewer line. Suburban Water will be onsite 1/10/22 but may not know where the either of the two water lines are located. We are on sending out a RFP for construction inspection 1/7/22 and bidding the project in in the coming weeks for 2022 construction possibly beginning in May. Determined working days for CE and construction of 120 days.

**Proposed Schedule:**

	<b>CE Services RFP Advertise</b>	<b>Thursday, January 6, 2022</b>
<b>1</b>	CE Proposal Due	Thursday, January 27, 2022
	Selection Committee	Wednesday, February 2, 2022
	RBA	Thursday, February 3, 2022
<b>2</b>	RBA Approval	Wednesday, February 9, 2022
<b>3</b>	Construction Bid Advertise:	Thursday, February 3, 2022
<b>4</b>	Letting/RBA:	Thursday, March 3, 2022
<b>5</b>	Low Bid Approval/Notice of Award:	Wednesday, March 9, 2022
	Contract Documents Returned:	Monday, March 21, 2022



**COUNTY OF LEAVENWORTH**  
DEPARTMENT OF PUBLIC WORKS



<b>6</b>	Contract Approval/NTP:	Wednesday, March 23, 2022
<b>8</b>	Early Start	Monday, May 2, 2022
	Late Start	Thursday, June 2, 2022

iv. **E-18** – We are going to try to bid this project in February. There is still a phone line and a gas line in conflict. Staff has little confidence that Benesch will be successful coordinating utilities. We will be verifying that all necessary work is underway next week. Determined working days for CE and construction of 165 days.

**Proposed Schedule:**

	<b>CE Services RFP Advertise</b>	<b>Thursday, January 6, 2022</b>
<b>1</b>	CE Proposal Due	Thursday, January 27, 2022
	Selection Committee	Wednesday, February 2, 2022
	RBA	Thursday, February 3, 2022
<b>2</b>	RBA Approval	Wednesday, February 9, 2022
<b>3</b>	Construction Bid Advertise:	Thursday, February 10, 2022
<b>4</b>	Letting/RBA:	Thursday, March 10, 2022
<b>5</b>	Low Bid Approval/Notice of Award:	Wednesday, March 16, 2022
	Contract Documents Returned:	Monday, March 28, 2022
<b>6</b>	Contract Approval/NTP:	Wednesday, March 30, 2022
<b>8</b>	Late Start	Thursday, May 19, 2022
	Late Finish	Tuesday, November 15, 2022

**ST-100 Bridge Replacement Project – Off-System Bridge Program**

- Finney and Turnipseed was approved by the BoCC for the design and construction inspection on the project.
- KDOT contract is before you for your consideration of guaranteeing our 20% funding.
- Per KDOT’s project schedule, the project’s construction should start in March 2023.

**E-48 Bridge Replacement Project – Local Bridge Grant Program**

- BoCC accepted the KDOT grant for \$150,000.
- Met onsite with a property owner and Husker Steel to discuss replacement options and existing utilities.
- KDOT has not issued final funding windows for the project but we intend on building the structure in 2022.

**Tonganoxie Road HRRR Safety Improvement Project – MHS design/inspection**

- 90/10 cost share grant – High Risk Rural Roads Program



# COUNTY OF LEAVENWORTH

## DEPARTMENT OF PUBLIC WORKS



- KDOT has accepted MHS's proposal for hours for the design of the project. A KDOT standard form contract was completed and returned to KDOT. KDOT sent the notice to proceed to the county and MHS for preliminary engineering services to begin.

### **Regional Transportation Capital Improvement Plan and Study:**

- The BoCC accepted Staff recommendations for Kimley-Horn as their first choice and PEC as the second choice. The selection committee meets January 13<sup>th</sup> to vote on the consultant selection.

#### Allocated Amounts

KDOT	\$250,000
Leavenworth County	\$150,000
City of Leavenworth	\$90,000
Lansing	\$30,000
Basehor	\$15,000
Tonganoxie	\$15,000

## **Surveying**

Training is ongoing for the Survey Technician under my license. During the last quarter approximately 100 section corners have been recovered in northern Alexandria and Southern Easton Townships.

We are still advertising for a County Surveyor or a qualified County Surveyor Assistant. Over the past 8 months we have had no qualified applicants for the County Surveyor position and only one applicant for the County Surveyor Assistant position. He was offered the position after an interview process. He turned down the position after several weeks of consideration.

## **Planning and Zoning - Engineering and Survey Reviews**

### **SUPs - Engineering Review Only**

American Frontier Productions  
Basehor Linwood School  
Conley Siteworks  
CW Lawns  
Dave's Construction  
Deer Ridge  
Dusselier Boat  
Forever Fence  
Freedom Revival  
Grinter Farms  
Happy Trails Kennel  
Integrity Tree  
Kraemer  
Turkey Creek Cycles



COUNTY OF LEAVENWORTH  
DEPARTMENT OF PUBLIC WORKS



**Subdivision Plats - Engineering & Survey Review**

AA Estates  
Bretz Farms  
Brockert Hill  
Burr Oaks  
Carbaugh  
Emerald Estates  
Grey's Corner  
Haines Corner  
Harman Farm  
High Prairie  
Johnson Corner  
Kitty Hawk  
Lee Chiles  
Redford  
Rolling K  
Roman Ridge  
Wards Ridge  
Mills Woods

**Surveys, Splits, BLAs & In-City Reviews - Survey Review Only**

204 Kickapoo  
Alta NSPS  
Arroyo  
Bill New  
Blockburger  
Engelhardt  
FEW  
Greystone  
Heim BLA  
Herring BLA 2021  
Herring BLA Shawnee  
Howard  
Howey  
Ingles  
Knetter  
LCP BL 30  
Lot 12 Highlands FL  
Lot 5 Highlands of FL  
Lozenski  
McEvoy RCH Holdings  
McGee Lot 4-7  
McGee Lot Split 13 & 14  
McGee Lot Split 17 & 18  
McGee Lot Split 3



# COUNTY OF LEAVENWORTH

## DEPARTMENT OF PUBLIC WORKS



McGee Lot Split 9  
MDR Farms  
MDR Farms 2  
Miller  
Moonlight Revision  
O'Hare  
Oscar  
Patterson Graveman  
Pierce  
Pierce Lot  
Prosser  
Rowe  
Runnebaum  
Rutledge  
Swilliams  
Theis  
VanCleave  
Vaught  
Warn Elder  
West Village  
Willis  
Younger  
Zuber  
Zuber 2

## **Fleet Management – See Attached Spreadsheet**

We have been very successful selling items on PurpleWave during the last quarter. Staff has worked together to write specs for each piece of equipment that has been purchased. We are no longer purchase directly off of no-local bid state contracts.

## **GIS Department Quarterly Performance**

The Leavenworth County GIS department is working hard to update all data on a weekly basis to the county's newly [released website](#). Also, update the [Integrity](#) website on a daily basis. The department has also updated all data and even created new data from scratch, which is available free of charge in [PDF](#), [shapefile format](#), and [CAD](#).

### **Accomplishments from June 2021 to present**

- ✓ Updated all GIS public layers on our new GIS web map and ArcGIS HUB, including shapefiles and PDFs that allow anyone with an internet connection to use them.
- ✓ Over eighty (80) new homesites were added to NG911 address points to be used by EMS, Fire department and shared with Cities.



# COUNTY OF LEAVENWORTH

## DEPARTMENT OF PUBLIC WORKS



- ✓ Worked on Census 2020 Blocks, groups, and Population data
- ✓ Mapped new voting districts with 2020 population.
- ✓ Submitted NG911-Q3 data for PSAP Leavenworth County Sheriff's Office
- ✓ Mapped and Uploaded Floodplain 2021 to our online webpages, also can be downloaded as Pdf, shapefile, and CAD formats.
- ✓ Processed the sync of NG911 GIS data and Parcel data with the LV city.
- ✓ Seven hundred thirty-four (1000) survey records were mapped and added to our GIS database. Moreover, 350 records were added to our online database and will update on a daily basis
- ✓ Two hundred and ninety seven (297) accidents, one hundred forty nine (1490) complaints, sixty five (65) utility Permits, three hundred and forty-one (531) traffic sign inventory, and twenty-two (37) entrance permits were logged and mapped.
- ✓ Ninety-seven (107) archive maps were scanned.
- ✓ 3-Year Cycle projected maintenance map (2021, 2022, and 2023 projected) was updated and mapped.
- ✓ 3-Year Cycle projected maintenance map (2022, 2023, and 2024 projected) was mapped.
- ✓ 2021 Grader Snow Routes and 2021 Traffic Counts were mapped
- ✓ Updated parcel data and shared with Kansas state and MARC
- ✓ Completed and submitted review of 2022 county aerial photography
- ✓ Filled 65 requests from external organizations.
- ✓ Over 96 AgUse changes
- ✓ Over 15 right of way adjustment mapped
- ✓ Over 86 Track Splits/Combinations/Boundary Line Adjustments made to Appraisal Property database.
- ✓ Twelve (20) new Subdivisions were added to the Appraisal Subdivision layer.
- ✓ Four (8) protest petitions were validated.
- ✓ Sidewalks and alleyways layers were created for the whole county.
- ✓ Updated new Neighborhood map for Appraiser's office.
- ✓ Intersections layer was created for potential travel cost analysis
- ✓ Worked with various Water Districts to update boundaries
- ✓ Python code was developed to update the property database every night.
- ✓ County Speed Limit, (2021) Grader Map, Easton Property Map, SD#1, SD#2, SD#5, (2021) County Routes Map, (2021) Township and Range Map, (2021) Project Map and Wastewater Map were updated.
- ✓ (2022) Culvert Replacement Map and (2021) Transfer station Traffic Flow Map were mapped.
- ✓ Started working on the Road Record Map

### Goals for Next Quarter

- ↳ Finishing Cemetery database
- ↳ Correcting topology errors
- ↳ Working on Road Record database. This will include Book/Page, Right of Way, Historical Road Names, Dates of Dedication, and a visible GIS Polyline file for documentation.





COUNTY OF LEAVENWORTH  
DEPARTMENT OF PUBLIC WORKS



**2021 Budget- Year End**

Road and Bridge	Budgeted \$9,809,726.00	YTD Spent \$9,648,675.00	Remaining 2%
Local Service	Budgeted \$3,606,264.00	YTD Spent \$3,553,119.65	Remaining 1%
Noxious Weed	Budgeted \$516,066.00	YTD Spent \$498,763.80	Remaining 3%
GIS	Budgeted \$257,283.00	YTD Spent \$125,236.04	Remaining 51%

Personnel – 72 positions, 68 filled (2 of those are 1,000/IOC positions) and 4 vacant.

As of January 2022, we have two vacant full-time positions opened- County Surveyor and GIS Analyst. Two others are IOC, Noxious Weed assistant and Engineering assistant.

Soma San's and Tim Urban's salaries have been moved over to the GIS budget for the 2022 budget year. They were previously coming out of Road and Bridge

# **Project Cost Breakdown**

## **Eisenhower Road**

## KINGS CONTRACT & CHANGE ORDERS (171)

CO #	DATE	AGREEMENT	COST	Board App'd
0	11/11/2020	Initial Contract	\$ 5,883,421.55	\$ 6,178,421.55
1	1/8/2021	Addition of Bid Alt 2 (Traffic Signal Installation)	\$ 260,950.00	\$ 260,950.00
		Omitted Bid Tab Items		
2	1/25/2021	Asbestos Abatement	\$ 5,460.00	
3	6/22/2021	Geogrid & 18" Storm Pipe	\$ 11,690.50	
4	7/15/2021	Sidewalk Retaining Wall	\$ 6,000.00	
5	7/15/2021	Additional Sidewalk Ramps	\$ 18,224.00	
6	7/15/2021	Tract 17 Entrance Relocation	\$ 1,150.00	
7	8/12/2021	Stormwater Structure	\$ 4,900.00	
8	8/16/2021	Entrance	\$ 2,616.00	
9	8/16/2021	Tract 4 Entrance	\$ 1,600.00	
10	10/21/2021	Branches Sidewalk Repair	\$ 873.80	
11	11/30/2021	Service for Streetlights	\$ 3,750.00	
		Total	\$ 56,264.30	
12	12/29/2021	Contract Quantity Error Balancing	\$ 53,181.18	
13	5/15/2021	Wilson Payment for Plan Error	\$ 128,163.15	
<span style="color: red;">TOTAL COUNTY COST</span>			\$ 6,253,817.03	\$ 6,439,371.55
TOTAL PROJECT COST			\$ 6,381,980.18	

APPROVED CONSTRUCTION SURPLUS FUNDS \$ 185,554.52

## Wilson Engineering Design Cost

1	4/4/2014	Original Contract	\$ 899,910.00
2	10/30/2017	BMP Feasibility Agreement	\$ 4,914.00
3	11/27/2017	Traffic Study Supplemental	\$ 4,125.00
4	9/26/2018	Hydrodynamic Separator Design	\$ 52,400.00
5	12/20/2018	Additional Topo Suvey Work	\$ 4,500.00
		Total	\$ 965,849.00

## Land Acquisition

See Attached Graph

Total	\$ 435,074.00
-------	---------------

## Utility Relocation

Total	\$ 139,757.00
-------	---------------

## Construction Engineering - MHS

				Board App'd
1	10/7/2020	Original Contract	\$ 333,339.08	\$ 350,039.08
2	12/30/2021	Continued SWPPP Hourly		
		Total	\$ 333,339.08	

## Advertisement, Plan Printing, Misc

Total \$ 56,854.31

## TOTAL PROJECT COST

**TOTAL** \$ 8,184,690.42

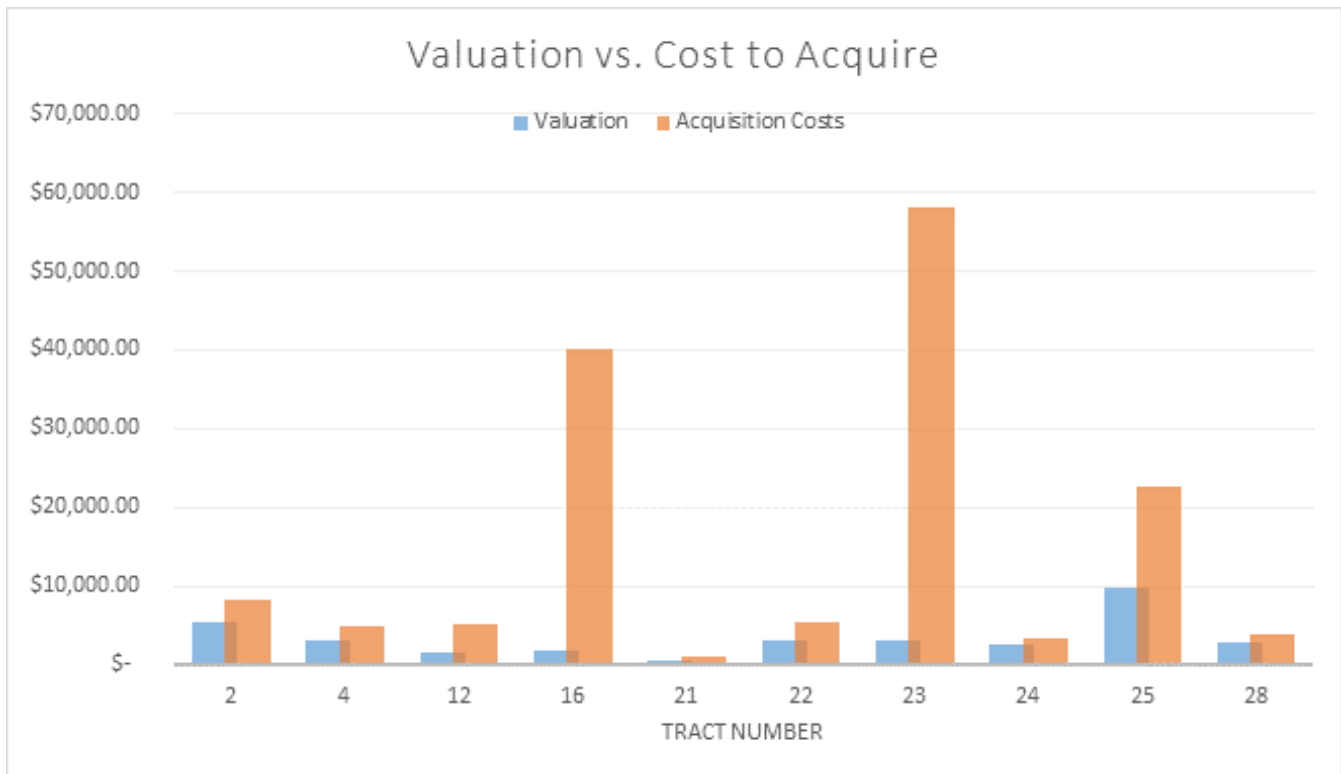

## **Project Cost Breakdown**

# **SH-22 Bridge Replacement**

## KING CONTRACT

CO #	DATE	AGREEMENT	COST
1	3/10/2021	Initial Contract	\$ 1,383,095.00
		NO CHANGE ORDERS	

**TOTAL COUNTY CONSTRUCTION COST** \$ 1,382,587.45

Remaining Budget After Completion \$ 507.55

## Finney and Turnipseed Engineering Cost

1	4/4/2014	Original Contract	\$ 72,000.00
		<b>Total</b>	\$ 72,000.00

## Land Acquisition

**Total** \$ 9,086.17

## Utility Relocation

**Total** \$ -

## Construction Engineering - Finney and Turnip.

1	10/7/2020	Original Contract	\$78,639
		Remaining Budget After Completion	

## TOTAL PROJECT COST

**TOTAL** \$ 1,542,312.62

Remaining Budget After Completion \$ 20,368.55

## **Project Cost Breakdown**

# **SH-30 Bridge Replacement**

## DONDLINGER CONTRACT

CO #	DATE	AGREEMENT	COST
1	12/30/2020	Initial Contract NO CHANGE ORDERS	\$ 612,269.31

**TOTAL COUNTY CONSTRUCTION COST** \$ 603,966.21

Remaining Budget After Completion \$ 8,303.10

## Benesch Engineering Cost

1	10/9/2017	Original Contract	\$ 49,676.00
2	12/18/2019	Supplemental Services Contract	\$31,170
		<b>Total</b>	\$ 80,846.00

## Land Acquisition

**Total** \$ 25,132.00

## Utility Relocation

**Total** \$ -

## Construction Engineering - Finney and Turnip.

1	10/7/2020	Original Contract	\$ 39,696.00
		Remaining Budget After Completion	

## TOTAL PROJECT COST

**TOTAL** \$ 749,640.21

Remaining Budget After Completion \$ 19,927.10



## **Project Cost Breakdown**

# **2022 Projects and Beyond**

158 <sup>th</sup> Street Road Improvement Project – Kansas Cost Share Program			
<b>Construction Schedule:</b>	KDOT Cost Share Grant - Federal Fiscal Year 2022 (Oct. 1, 2021 - Sept. 30, 2022) Construction Bidding Submitted 1/13/2022 Construction Notice to Proceed 2/14/2022 Construction Completion 10/1/2022		
<b>Status:</b>	Construction Bids Submitted 1/13/2022 Property Acquisition Complete		
<b>Estimated Total Project Cost:</b>	\$3,319,000 (\$2,419,000 Local Funds)		
<b>Funding Source:</b>	KDOT Cost Share (\$900,000), Sales Tax		
	<b>Amount</b>	<b>Remaining</b>	<b>% Complete</b>
<b>Design Contract (MHS):</b>	\$ 70,569.15	\$ -	100%
<b>Inspection Contract (MHS):</b>	\$ 207,580.28	\$ 196,573.94	5%
<b>Construction Estimate</b>	\$ 2,900,450.00	\$ 2,900,450.00	0%

Tonganoxie Road Safety Improvements - KDOT High Risk Rural Roads (HRRR)			
<b>Construction Schedule:</b>	Spring/Summer 2023		
<b>Status:</b>	Agreement finalized for Preliminary Engineering with KDOT, MHS & LVCO - 90% KDOT Funded		
<b>Estimated Project Cost:</b>	\$1602222.23 (\$207,000 Local Funds)		
<b>Funding Source:</b>	Sales Tax & KDOT		
	<b>Amount</b>	<b>Remaining</b>	<b>% Complete</b>
<b>Design Contract (MHS):</b>	\$ 198,222.23	\$ 198,222.23	0%
<b>Inspection Estimate (MHS):</b>	\$ 183,000.00	\$ 183,000.00	0%
<b>Construction Estimate:</b>	\$ 1,221,000.00	\$ 1,221,000.00	0%

**235th St (Hollingsworth to Dempsey) – Wilson**

<b>Construction Schedule:</b>	Completion Q4 2023		
<b>Status:</b>	Design complete		
<b>Estimated Project Cost:</b>	\$4,340,000		
<b>Funding Source:</b>	Tonganoxie Township Fund & Sales Tax		
	<b>Amount (Estimated)</b>	<b>Remaining</b>	<b>% Complete</b>
<b>Design Contract (Wilson):</b>	\$ 75,400.00	\$ 3,620.00	95%
<b>Inspection Contract (TBD):</b>	\$ 360,000.00	\$ 360,000.00	0%
<b>Construction Contract (TBD):</b>	\$ 3,600,000.00	\$ 3,600,000.00	0%

**Bridge HP-19**

<b>Construction Schedule:</b>	Construction Start: 3/14/2022-5/16/2022		
<b>Status:</b>	Construction & Construction Engineering Services under contract.		
<b>Estimated Project Cost:</b>	\$2,031,000		
<b>Funding Source:</b>	High Prairie Township Fund & Special Highway Fund		
	<b>Amount (Estimated)</b>	<b>Remaining</b>	<b>% Complete</b>
<b>Design Contract (Wilson):</b>	\$ 192,430.00	\$ -	100%
<b>Inspection Contract (TBD):</b>	\$ 134,900.00	\$ 134,900.00	0%
<b>Construction Contract (TBD):</b>	\$ 1,589,686.35	\$ 1,589,686.35	0%

**Bridge A-49 – Benesch**

<b>Construction Schedule:</b>	Construction Bidding in 4th Quarter 2023		
<b>Status:</b>	Design complete		
<b>Estimated Project Cost:</b>	\$773,000		
<b>Funding Source:</b>	Alexandria Township (If available funds) & Special Highway Fund		
	<b>Amount (Estimated)</b>	<b>Remaining</b>	<b>% Complete</b>
<b>Design Contract (Benesch):</b>	\$ 75,362.00	\$ 2,637.67	97%
<b>Inspection Contract (TBD):</b>	\$ 87,000.00	\$ 87,000.00	0%
<b>Construction Contract (TBD):</b>	\$ 555,000.00	\$ 555,000.00	0%

Bridge T-34 – Benesch			
Construction Schedule:	Construction Bidding in 4th Quarter 2023		
Status:	Design complete		
Estimated Project Cost:	\$822,000		
Funding Source:	Tonganoxie Township (If Available) & Special Highway Fund		
	Amount (Estimated)	Remaining	% Complete
Design Contract (Benesch):	\$ 83,556.00	\$ 26,687.36	68%
Inspection Contract (TBD):	\$ 90,000.00	\$ 90,000.00	0%
Construction Contract (TBD):	\$ 600,500.00	\$ 600,500.00	0%

Bridge F-46 – Benesch			
Construction Schedule:	Construction Engineering Services RFP sent to firms		
Status:	Design Complete & Contract Documents under Review		
Estimated Project Cost:	\$650,000		
Funding Source:	Fairmount Township (If Available), ARPA Funds, & Special Highway Fund		
	Amount (Estimated)	Remaining	% Complete
Design Contract (Benesch):	\$ 77,200.00	\$ 9,264.00	88%
Inspection Contract (TBD):	\$ 75,000.00	\$ 75,000.00	0%
Construction Contract (TBD):	\$ 490,000.00	\$ 490,000.00	0%

Bridge E-18 – Benesch			
Construction Schedule:	Construction Engineering Services RFP sent to firms		
Status:	Design Complete & Contract Documents under Review		
Estimated Project Cost:	\$1,270,000		
Funding Source:	Easton Township (If Available), ARPA Funds, & Special Highway		
	Amount (Estimated)	Remaining	% Complete
Design Contract (Benesch):	\$ 106,225.00	\$ 10,888.06	90%
Inspection Contract (TBD):	\$ 103,000.00	\$ 103,000.00	0%
Construction Contract (TBD):	\$ 1,030,000.00	\$ 1,030,000.00	0%

Bridge K-45 – Norfolk Contracting			
Construction Schedule:	Q1/Q2 2022		
Status:	Utility relocation in coordination		
Estimated Project Cost:	\$110,058		
Funding Source:	Watershed Institute Funding, Kickapoo Township		
	Amount (Estimated)	Remaining	% Complete
Design/Construction Contract (Norfolk Contracting):	\$ 169,320.00	\$ 169,320.00	0%
Inspection Contract (TBD):	\$ 25,398.00	\$ 25,398.00	0%

**Bridge ST-100 – Finney & Turnipseed**

<b>Construction Schedule:</b>	Completion anticipated Fall 2023		
<b>Status:</b>	Design contract underway		
<b>Estimated Project Cost:</b>	\$835,000 (\$272,000 Local Funding)		
<b>Funding Source:</b>	Stranger Township (If Available) & Special Highway Fund		
	<b>Amount (Estimated)</b>	<b>Remaining</b>	<b>% Complete</b>
<b>Design Contract (Benesch):</b>	\$ 90,000.00	\$ 90,000.00	0%
<b>Inspection Contract (TBD):</b>	\$ 77,000.00	\$ 77,000.00	0%
<b>Construction Contract (TBD):</b>	\$ 630,000.00	\$ 630,000.00	0%

**Bridge E-48 - No Contracts**

<b>Construction Schedule:</b>	2022		
<b>Status:</b>	Notification of Award from KDOT, No contracts final		
<b>Estimated Project Cost:</b>	\$485,000		
<b>Funding Source:</b>	Fairmount Township (If Available), ARPA Funds, & Special Highway Fund		
	<b>Amount (Estimated)</b>	<b>Remaining</b>	<b>% Complete</b>
<b>Design Contract (Benesch):</b>	\$ 75,000.00	\$ 75,000.00	0%
<b>Inspection Contract (TBD):</b>	\$ 24,000.00	\$ 24,000.00	0%
<b>Construction Contract (TBD):</b>	\$ 350,000.00	\$ 350,000.00	0%

**Eastern Gateway Concept Study**

<b>Status:</b>	No progress
<b>Contract Amount:</b>	\$91,540
<b>Funding Source:</b>	Sales Tax

**Regional Transportation Capital Improvement Plan Prioritization**

<b>Status:</b>	Proposals submitted, Stakeholder Selection Committee met 1/13
<b>Estimated Project Cost:</b>	\$550,000
<b>Funding Source:</b>	City/County/State Funding

**Olsson Engineering Services**

	Costs	Reduction of Use from Previous Year
2019 Annual Usage (Contracted 8/6):	\$ 102,269.32	
<b>2019 Monthly Average:</b>	<b>\$ 20,453.86</b>	
2020 Annual Usage:	\$ 224,817.81	

<b>2020 Monthly Average:</b>		\$	<b>18,734.82</b>	<b>8%</b>
2021 Annual Usage (through 12/22/2021):		\$	118,446.51	
<b>2021 Monthly Average:</b>		\$	<b>16,920.93</b>	<b>10%</b>
	<b>Planning &amp; Zoning Development Review</b>		<b>Public Works Engineering Services</b>	<b>Percent Split</b>
<b>2021 Contract Usage</b>				40.68% / 59.32%
	\$ 48,182.00	\$	70,264.51	
<b>Remaining Approved Contract Amount (as of 12/22/2021)</b>				\$ 35,006.36
<b>Status:</b>				
<p>Engineering Review of P&amp;Z applications (SUP, TSUP, Plats) to include pavement/surface impacts and traffic impacts</p> <p>Survey Review for County Surveyor Required Applications within cities and county</p> <p>Engineering review for current county projects (roadway plans, bridge plans, estimates, specifications)</p> <p>Assisted in preparation of RFPs for Eastern Gateway and Regional Transportation CIP</p>				

# **Fleet Management**

ENT #	New Vehicle#	Old Vehicle#	Department	Year	Make	Model	Vehicle Type	VIN#	Enterprise monthly	Camera monthly	GPS Monthly	GPS/CAM	Order approval	Date Delivered	Lease End
23JQS8	09-21	n/a	Council on Aging	2020	Chevrolet	Equinox	LS front wheel drive	3GNAXHEV2LS600624	\$ 395.28	\$ 19.95	\$ 16.33	8/12/2021		3/26/2020	04/2025
23M34S	09-01	5	Council on Aging	2020	Dodge	Grand Caravan	SE Front-wheel Drive Passenger Van wc	2C7WDGBGXR224861	\$ 544.47	\$ 19.00	\$ 16.33	10/20/2020		9/28/2020	10/2024
23M34X	09-02	12	Council on Aging	2020	Dodge	Grand Caravan	SE Front-wheel Drive Passenger Van	2C7WDGBG5LR227649	\$ 571.62	\$ 19.00	\$ 16.33	10/20/2020		9/28/2020	10/2024
23M35S	09-03	6	Council on Aging	2020	Dodge	Grand Caravan	SE Front-wheel Drive Passenger Van wc	2C7WDGBG3LR227651	\$ 547.86	\$ 19.00	\$ 16.33	10/20/2020		9/28/2020	10/2024
23MKR4	10-01	9b	Public Works	2020	Ford	F-250	XL 4x4 SD Crew Cab 6.75 ft. box 160 in. WB SRW	1FT7W2B60LED69572	\$ 831.85					9/28/2020	10/2021
23KBVR	00-01	no#	Planning & Zoning	2020	Ford	Escape	S 4 door all wheel drive	1FMCU9F68LUB84694	\$ 266.28	\$ 19.00	\$ 16.33	11/12/2020		11/4/2020	12/2025
23KBVS	09-10	36	Council on Aging	2020	Ford	Escape	S 4 door all wheel drive	1FMCU9F63LUB84909	\$ 278.56	\$ 19.00	\$ 16.33	11/12/2020		11/4/2020	12/2025
23KBVV	02-04	APP11	Appraiser	2020	Ford	Escape	S 4 door all wheel drive	1FMCU9F66LUB84709	\$ 354.63	\$ 19.00	\$ 16.33	11/5/2020		11/4/2020	12/2025
23KBZS	09-08	15	Council on Aging	2020	Ford	Escape	S 4 door all wheel drive	1FMCU9F64LUB84921	\$ 381.49	\$ 19.00	\$ 16.33	11/5/2020		11/4/2020	12/2025
23KBZX	09-06	22	Council on Aging	2020	Ford	Escape	S 4 door all wheel drive	1FMCU9F66LUB84841	\$ 379.50	\$ 19.00	\$ 16.33	11/12/2020		11/4/2020	12/2025
23LZGG	09-12	1	Council on Aging	2020	Ford	Transit 350	XL Rear-wheel Drive Medium Roof Van 148 in. WB	1FDAX2C8XKA98634	\$ 719.20	\$ 19.00	\$ 16.33	12/9/2020		12/8/2020	01/2026
23LR6M	10-02	88a	Public Works	2020	Ford	F-250	XL 4x4 SD Crew Cab 6.75 ft. box 160 in. WB SRW	1FT7W2B60LEE96838	\$ 470.19	\$ 19.00	\$ 16.33	1/14/2021		1/11/2021	02/2022
23KBVX	09-07	33	Council on Aging	2020	Ford	Escape	S 4 door all wheel drive	1FMCU9F6XLUB84664	\$ 323.80	\$ 19.95	\$ 16.33	4/6/2021		1/13/2021	02/2026
23KC26	09-05	19	Council on Aging	2020	Ford	Escape	S 4 door all wheel drive	1FMCU9F63LUB84635	\$ 383.86	\$ 19.95	\$ 16.33	4/9/2021		1/13/2021	02/2026
23LR6D	10-03	8a	Public Works	2020	Ford	F-250	XL 4x4 SD Crew Cab 6.75 ft. box 160 in. WB SRW	1FT7W2B60LEE96841	\$ 558.87	\$ 19.00	\$ 16.33	1/19/2021		1/13/2021	02/2022
23LR6V	10-04	129	Public Works	2020	Ford	F-250	XL 4x4 SD Crew Cab 6.75 ft. box 160 in. WB SRW	1FT7W2B69LEE96840	\$ 499.59	\$ 19.00	\$ 16.33	1/21/2021		1/13/2021	02/2022
23KBW3	11-01	no#	Comm. Corrections	2020	Ford	Escape	S 4 door all wheel drive	1FMCU9F65LUB84622	\$ 29.54	\$ 19.95	\$ 16.33	2/11/2021		1/13/2021	02/2026
23LTQZ	06-02	54	Solid Waste	2020	Ford	F-250	XL 4x4 SD Crew Cab 6.75 ft. box 160 in. WB SRW	1FT7W2B62LEE96842	\$ 499.16	\$ 19.00	\$ 16.33	1/21/2021		1/13/2021	02/2022
23KBWD	10-11	89	Public Works	2020	Ford	Escape	S 4 door all wheel drive	1FMCU9F65LUB84720	\$ 220.18	\$ 19.00	\$ 16.33	2/26/2021		1/13/2021	02/2026
23KC28	09-11	24	Council on Aging	2020	Ford	Escape	S 4 door all wheel drive	1FMCU9F62LUB84626	\$ 377.72	\$ 19.00	\$ 16.33	3/4/2021		1/19/2021	02/2026
23KBW8	02-02	APP9	Appraiser	2020	Ford	Escape	S 4 door all wheel drive	1FMCU9F63LUB84702	\$ 359.77	\$ 19.95	\$ 16.33	4/19/2021		1/19/2021	02/2026
23KBWC	02-05	APP15	Appraiser	2020	Ford	Escape	S 4 door all wheel drive	1FMCU9F64LUB84630	\$ 327.10	\$ 19.95	\$ 16.33	4/23/2021		1/19/2021	02/2026
23KC24	02-03	APP10	Appraiser	2020	Ford	Escape	S 4 door all wheel drive	1FMCU9F69LUB84932	\$ 368.98	\$ 19.95	\$ 16.33	4/16/2021		1/19/2021	02/2026
23KC2B	02-01	APP8	Appraiser	2020	Ford	Escape	S 4 door all wheel drive	1FMCU9F60LUB84639	\$ 360.85	\$ 19.95	\$ 16.33	4/19/2021		1/19/2021	02/2026
23KBWS	09-04	29	Council on Aging	2020	Ford	Escape	S 4 door all wheel drive	1FMCU9F63LUB84487	\$ 340.04	\$ 19.00	\$ 16.33	3/16/2021		2/3/2021	03/2026
23LR73	03-01	206	Noxious Weed	2020	Ford	F-250	XL 4x4 SD Crew Cab 6.75 ft. box 160 in. WB SRW	1FT7W2B62LEE96839	\$ 375.80	\$ 19.95	\$ 16.33	3/15/2021		2/26/2021	03/2022
23NLQS	09-09	31	Council on Aging	2021	Ford	F-250	XL 4x4 SD Regular Cab 8 ft. box	1FTBF2B69MED04554	\$ 424.03	\$ 19.00	\$ 16.33	3/26/2021		3/17/2021	04/2022
23NLLK	06-01	531	Solid Waste	2021	Ford	F-250	XL 4x4 SD Crew Cab 6.75 ft. box 160 in. WB SRW	1FT7W2B63MED04555	\$ 432.82	\$ 19.95	\$ 16.33	4/20/2021		4/19/2021	05/2022
23TBQF	10-10	replaces 1	Public Works	2021	Ford	Escape	S 4 door all wheel drive	1FMCU9F6XMA61156	\$ 413.25	\$ 19.95	\$ 16.33	6/24/2021	1/22/2021	6/9/2021	07/2026
23TBM3	12-00	replaces no#	Attorney	2021	Ford	Escape	S 4 door all wheel drive	1FMCU9F65MUA60674	\$ 413.25	\$ 19.95	\$ 16.33	6/11/2021	1/22/2021	6/11/2021	07/2026
23TMXT	10-05	replaces 10a	Public Works	2021	Ford	F-350	Utility box 1 ton	1FDRF3HN0MDA03515	\$ 869.38	\$ 19.95	\$ 16.33	6/24/2021	2/1/2021	6/17/2021	07/2026
23SLD7	04-01	replaces 97	B&G	2021	Ford	F-250	XL 4x4 SD Crew Cab 6.75 ft. box 160 in. WB SRW	1FT7W2B65MED45284	\$ 712.32	\$ 19.95	\$ 16.33	7/16/2021	12/29/2020	7/14/2021	08/2022
23SLDH	04-00	replaces 98	B&G	2021	Ford	F-250	XL 4x4 SD Crew Cab 6.75 ft. box 160 in. WB SRW	1FT7W2B63MED45283	\$ 712.32	\$ 19.95	\$ 16.33	7/20/2021	12/29/2020	7/14/2021	08/2022
23SBRB	10-08	replaces 128	Public Works	2021	Ford	F-250	XL 4x4 SD Crew Cab 6.75 ft. box 160 in. WB SRW	1FT7W2B6XMED45281	\$ 658.92	\$ 19.95	\$ 16.33	11/29/2021	12/20/2020	10/8/2021	12/2022
23SBS8	10-07	replaces 127	Public Works	2021	Ford	F-250	XL 4x4 SD Crew Cab 6.75 ft. box 160 in. WB SRW	1FT7W2B61MED45282	\$ 665.33	\$ 19.95	\$ 16.33	1/5/2021	12/20/2020	10/29/2021	12/2022
23SBQK	10-09	REPLACES 130	Public Works	2021	Ford	F-250	XL 4x4 SD Crew Cab 6.75 ft. box 160 in. WB SRW	1FT7W2B68MED45280	\$ 665.33	\$ 19.95	\$ 16.33	12/1/2021	12/20/2020	10/29/2021	12/2022
23WQT7	10-06	replaces 111a	Public Works	2022	Ford	F-550	enclosed Utility box 1.5 ton	1FDOW5HN6NEC75325	\$ 1,034.71	\$ 19.95	\$ 16.33	12/23/2021	9/28/2021	12/20/2021	1/2027



**Vehicles ordered but not delivered yet**

ENT #	New Vehicle#	Old Vehicle#	Department	Year	Make	Model	Vehicle Type	VIN#	Enterprise monthly	Camera monthly	GPS Monthly	GPS/CAM	Order approval	
23SKVL	09-17	replaces 2	Council on Aging	2021	Ford	Transit 350	XL Rear-wheel Drive Med. Roof Van 148 in. WB	1FDAX2C85MKA73769	\$ 915.10	\$ 19.95	\$ 16.33		12/30/2020	wex
23XS4K	10-01	replaces 10-01	Public Works	2022	Ford	F-250	XL 4x4 SD Crew Cab 6.75 ft. box 160 in. WB SRW		\$ 639.64	\$ 19.95	\$ 16.33		5/12/2021	
25458W	ADMIN3	ADMIN3	EMS	2022	Ford	F-250	XL 4x4 SD Crew Cab 6.75 ft. box 160 in. WB SRW		\$ 695.55				7/13/2021	
256WKL	SUP1	SUP1	EMS	2022	Ford	Utility Police Int.	Explorer all wheel drive	1FM5K8AW8NNA04143	\$ 867.79				7/13/2021	
256WNW	PAR2	PAR2	EMS	2022	Ford	Utility Police Int.	Explorer all wheel drive	1FM5K8AW4NNA04317	\$ 867.79				7/13/2021	
254FKV		Replaces 5a	Public Works	2022	Ford	f250	4x4 reg cab 8' bed		\$ 612.44	\$ 19.95	\$ 16.33	12/3/2021	7/26/2021	
254QCH		93	Public Works	2022	Ford	F-350	Regular cab 4x4 w 8' flatbed		\$ 942.37	\$ 19.95	\$ 16.33	7/27/2021	8/6/2021	
254S9T		94	Public Works	2022	Ford	F-350	xl 4x4 flatbed, plow,spreader, spray tank		\$ 943.66	\$ 19.95	\$ 16.33	12/2/2021	8/6/2021	
2556H4	10-02	replaces 10-02	Public Works	2022	Ford	F-250	XL 4x4 SD Crew Cab 6.75 ft. box 160 in. WB SRW		\$ 607.25				8/6/2021	
2556J7	10-03	replaces 10-03	Public Works	2022	Ford	F-250	XL 4x4 SD Crew Cab 6.75 ft. box 160 in. WB SRW		\$ 607.25				8/6/2021	
2556JJ	10-04	replaces 10-04	Public Works	2022	Ford	F-250	XL 4x4 SD Crew Cab 6.75 ft. box 160 in. WB SRW		\$ 607.25				8/6/2021	
259LQR		17	Council on Aging	2022	Ford	Transit 350	XL Rear-wheel Drive High Roof Van 148 in. WB	1FBVU4X89NKA06991	\$ 863.97	\$ 19.95	\$ 16.33		9/23/2021	Transit with 34"x76" bus door
259C5C		18	Council on Aging	2017	Chevrolet	Silverado 1500	4x2 reg cab 6.6" bed catering box	1GCNCNEH9HZ124512	\$ 971.98	\$ 19.95	\$ 16.33		9/23/2021	Transit with hot/cold catering box all wheel drive
259PGJ	stolen totaled	replaces 27	Council on Aging	2019	Chevrolet	Equinox	LS front wheel drive	2GNAXKEV4K6128694	\$ 971.98	\$ 19.95	\$ 16.33		9/23/2021	Transit with hot/cold catering box all wheel drive
		replaces 34	Council on Aging	2001	Dodge	caravan	SE Front-wheel Drive Passenger Van	2B4GP44301R347807	\$ 615.57	\$ 19.95	\$ 16.33		11/16/2021	minivan
		replaces 35	Council on Aging	2005	Dodge	caravan	SE Front-wheel Drive Passenger Van	1D4GP25R45B377992	\$ 615.57	\$ 19.95	\$ 16.33		11/16/2021	minivan
		replaces25	Council on Aging	2008	Chev	Uplander	van	1GNDU23W58D190813	\$ 615.57	\$ 19.95	\$ 16.33		11/16/2021	minivan
		replaces 30	Council on Aging	2005	Ford	Expedition	SUV	1FMPU16575LA90342	\$ 615.57	\$ 19.95	\$ 16.33		11/16/2021	minivan
		replaces 23	Council on Aging	2014	Ford	Escape	SUV	1FMCU9GX7EUA78540	\$ 615.57	\$ 19.95	\$ 16.33		11/16/2021	minivan
	nlu sent	replaces 26	Council on Aging	2012	Ford	Escape	SUV	1FMCU9C78CKA23870	\$ 615.57	\$ 19.95	\$ 16.33		11/16/2021	minivan
		replaces 13	Council on Aging	2013	Dodge	Grand Caravan	Front-wheel Drive Passenger Van w/c	2C4RDGGBGXDR787226	\$ 862.01	\$ 19.95	\$ 16.33			w/c van
		replaces 14	Council on Aging	2015	Dodge	Grand Caravan	Front-wheel Drive Passenger Van w/c	2C7WDGGBG2FR614180	\$ 862.01	\$ 19.95	\$ 16.33			w/c van
	stolen REPAIRED	replaces 9	Council on Aging	2018	Dodge	Grand Caravan	Front-wheel Drive Passenger Van w/c	2C7WDGGBG4JR363588	\$ 862.01	\$ 19.95	\$ 16.33			w/c van

**Vehicles to be ordered next**

	09-09	replaces 09-09	Council on Aging	2021	Ford	F-250	XL 4x4 SD Regular Cab 8 ft. box	1FTBF2B69MED04554		camera in	gps in			f-250 reg cab
	06-01	replaces 06-01	Solid Waste	2021	Ford	F-250	XL 4x4 SD Crew Cab 6.75 ft. box 160 in. WB SRW	1FT7W2B63MED04555		camera in	gps in			f-250 crew cab
	06-02	replaces 06-02	Solid Waste	2021	Ford	F-250	XL 4x4 SD Crew Cab 6.75 ft. box 160 in. WB SRW	1FT7W2B62LEE96842		camera in	gps in			f-250 crew cab
	03-01	replaces 03-01	Noxious Weed	2021	Ford	F-250	XL 4x4 SD Crew Cab 6.75 ft. box 160 in. WB SRW	1FT7W2B62LEE96839		camera in	gps in			f-250 crew cab

Estimated monthly cost in red

**Future vehicles targeted for replacement**

ENT #	New Vehicle#	Old Vehicle#	Department	Year	Make	Model	Vehicle Type	VIN#	Enterprise monthly	Camera monthly	GPS monthly	GPS/CAM			
		ADMIN 1	EMS	2014	Ford	Utility Police Int.	Explorer all wheel drive	1FM5K8AR1EGC49624							
		ADMIN2	EMS	2017	Ford	Utility Police Int.	Explorer all wheel drive	1FM5K8AR0HGC56794							
		ADMIN4	EMS	2017	Ford	Utility Police Int.	Explorer all wheel drive	1FM5K8AR2HGC56795							
		8	Council on Aging	2017	Dodge	Grand Caravan	passenger van W/C	2C4RDGBG2HR843178		\$ 19.95	\$ 16.33				
		202b	Noxious Weed	2017	Chevrolet	Silverado 3500hd	4x4 reg cab,137.5"wb ,plow, sander, spray tank	1GB3KYG2HF165849		\$ 19.95	\$ 16.33	5/11/2021			
		204b	Noxious Weed	2017	Ford	F-550	4x4 supercab 168"wb	1FD0X5HT0HEB62714		\$ 19.00	\$ 16.33	4/2/2021			
		299b	Noxious Weed	2017	Chevrolet	Silverado 3500hd	4x4 reg cab, 137.5"wb,plow,sander,spray tank	1GB3KYC4HF166324		\$ 19.95	\$ 16.33	5/6/2021			
		PZ1	Planning & Zoning	2018	Chevrolet	Silverado 1500	4x4 double cab 6.6" bed	1GCVKNEC4JZ185084		\$ 19.95	\$ 16.33	12/13/2021			
		2	Public Works	2018	Chevrolet	Silverado 1500	4x4 double cab 6.6" bed	1GCVKNEC5JZ109258		\$ 19.95	\$ 16.33	5/18/2021			f550 W HYD TILT BED
		6b	Public Works	2018	Chevrolet	Silverado 1500	4x4 double cab 6.6" bed	1GCVKNEC4JZ115360		\$ 19.95	\$ 16.33	5/18/2021			
		424	Solid Waste	2018	Ford	Escape	s front wheel drive	1FMCU0F73JUD38424		\$ 19.95	\$ 16.33				
	stolen REPAIRED	replaces 38	Council on Aging	2019	Chevrolet	Equinox	LT front wheel drive	2GNAXHEV0K6242145		\$ 19.95	\$ 16.33				minivan
		99	B&G	2019	Ford	F-250	4x4 reg cab ,bed , plow, sander	1FTBF2B65KEC42518		\$ 19.95	\$ 16.33	7/2/2021			
		APP1	Appraiser	2019	Ford	Fusion	s front wheel drive	3FA6P0G79KR239256		\$ 19.95	\$ 16.33	9/13/2021			
		APP2	Appraiser	2019	Ford	Fusion	s front wheel drive	3FA6P0G70KR239257		\$ 19.95	\$ 16.33	8/31/2021			
		20	Council on Aging	2019	Chevrolet	Equinox	LS front wheel drive	2GNAXHEV9K6289996		\$ 19.95	\$ 16.33				
		28	Council on Aging	2019	Chevrolet	Equinox	LS front wheel drive	2GNAXHEV8K6288290		\$ 19.95	\$ 16.33				
		4	Public Works	2019	Ford	F-250	4x4 reg cab, 8' bed, plow,sander	1FTBF2B67KEC42519		\$ 19.95	\$ 16.33	7/27/2021			
		401	Public Works	2019	RAM	1500 Classic	Tradesman 4x4 crew cab 140" wb. Special tool box	1C6RR7KT5KS692901		\$ 19.95	\$ 16.33	8/25/2021			
		3b	Public Works	2019	RAM	1500 Classic	Tradesman 4x4 crew cab 140" wb	1C6RR7KT9KS692903		\$ 19.95	\$ 16.33	9/15/2021			
		7	Public Works	2019	RAM	1500 Classic	Tradesman 4x4 crew cab 140" wb	1CRR7KT7KS692902		\$ 19.95	\$ 16.33	9/8/2021			
		05-00	Health Dept.	2020	Chevrolet	Traverse	LS w/1LS All-wheel Drive	1GNEVFKW9LJ145927							
			Health Dept.	2020	Chevrolet	Traverse	LS w/1LS All-wheel Drive	1GNEVFKW6LJ142886							

**Community correction vehicle not on Enterprise replacement Getting camera and GPS Installed**

		no number	Comm. corrections	2011	Ford	Fusion	sedan	3FAHP0GA0BR304354		\$ 19.95	\$ 16.33				
--	--	-----------	-------------------	------	------	--------	-------	-------------------	--	----------	----------	--	--	--	--

**Heavy Trucks and Equipment Getting camera and GPS Installed**

Vehicle#	Department	Year	Make	Model	Vehicle Type	VIN#	Camera monthly	GPS monthly	GPS/CAM
23B	Public Works LS	2019	CAT	140M3	Motorgrader	N9D01315	\$ 19.95	16.33	9/24/2021
24B	Public Works LS	2019	CAT	140M3	Motorgrader	N9D01269	\$ 19.95	16.33	11/8/2021
25	Public Works LS	2007	CAT	140H	Motorgrader	APM03185	\$ 19.95	16.33	
26	Public Works LS	2020	John Deere	770GP	Motorgrader	1DW770GPKLF708030	\$ 19.95	16.33	
27C	Public Works LS	2018	CAT	140M3	Motorgrader	N9D00923	\$ 19.95	16.33	
30C	Public Works LS	2018	CAT	140M3	Motorgrader	N9D01015	\$ 19.95	16.33	
31	Public Works LS	2020	John Deere	770GP	Motorgrader	1DW770GPKLF708033	\$ 19.95	16.33	
32C	Public Works LS	2017	CAT	140M3	Motorgrader	N9D00744	\$ 19.95	16.33	4/28/2021
80C	Public Works LS	2017	CAT	140M3	Motorgrader	N9D00743	\$ 19.95	16.33	8/11/2021
29	Public Works LS	2004	CAT	143H	Motorgrader	APN00458	\$ 19.95	16.33	
35	Public Works LS	2020	Case	580SN	Backhoe	JJGN58WTCLC774031	\$ 19.95	16.33	9/14/2021
36	Public Works LS	2020	Case	580SN	Backhoe	JJGN58WTLCC774034	\$ 19.95	16.33	
63	Public Works LS	2020	Case	580SN	Backhoe	JJGN58WTPLC774042	\$ 19.95	16.33	
11	PW heavy truck	2015	Freightline	108SD	Dump Truck	3ALHG5CY2FDGS7397	\$ 19.95	16.33	2/25/2021
13	PW heavy truck	2013	Freightline	108SD	Dump Truck	1FVHG5B57DHFH8133	\$ 19.00	16.33	4/1/2021
14B	PW heavy truck	2018	Freightline	108SD	Dump Truck	1FVHG4FE3JHJJ4581	\$ 19.95	16.33	3/5/2021
16	PW heavy truck	2012	Freightline	M2106V	Dump Truck	1FVHC3BSXCHBP5833	\$ 19.95	16.33	4/7/2021
17	PW heavy truck	2018	Freightline	108SD	Dump Truck	1FVHG5FE7JHJL3814	\$ 19.00	16.33	3/15/2021
18B	PW heavy truck	2019	Freightline	108SD	Dump Truck	1FVHG5FE0KHKS9012	\$ 19.95	16.33	9/8/2021
54	PW heavy truck	2012	Freightline	M2106V	Dump Truck	1FVHCBS7CDBL7919	\$ 19.95	16.33	6/2/2021
56	PW heavy truck	2015	Freightline	108SD	Dump Truck	3ALHG5CYXFDGS7406	\$ 19.95	16.33	3/15/2021
64	PW heavy truck	2019	Freightline	108SD	Dump Truck	1FVHG5FE2KHK9013	\$ 19.00	16.33	3/17/2021
66A	PW heavy truck	2014	Freightline	108SD	Dump Truck	3ALHG5CY2EDGA3613	\$ 19.95	16.33	3/10/2021
83	PW heavy truck	2018	Freightline	108SD	Dump Truck	1FVHG5FE 1JHJJ4577	\$ 19.00	16.33	3/5/2021
91B	PW heavy truck	2018	Freightline	108SD	Dump Truck	1FVHG5FE1JHJL3811	\$ 19.95	16.33	8/31/2021
50	PW heavy truck	2020	Freightline	108SD	Dump Truck	1FVHG5FE5LHLV0863	\$ 19.00	16.33	3/18/2021
51	PW heavy truck	2020	Freightline	108SD	Dump Truck	1FVHG5FE7LHLV0864	\$ 19.00	16.33	3/15/2021
13- 01	PW heavy truck	2021	Freightline	108SD	Dump Truck	3ALHG5FE6MDMX2168	\$ 19.00	16.33	3/18/2021
13- 02	PW heavy truck	2021	Freightline	108SD	Dump Truck	3ALHG5FE4MDMX2167	\$ 19.95	16.33	3/18/2021
106A	PW heavy truck	2015	Ford	F 550	Mower boom truck	1FDUF5HT2FEA22875	\$ 19.95	16.33	4/2/2021
42	PW heavy truck	2021	Freightline	M2 106	Entyre Oil Distributor/3500 gallon	3ALHCYFE5MDMS3461	\$ 19.95	16.33	4/19/2021
22	PW heavy Eq	2013	Etyre		Entyre Oil Distributor/3500 gallon	3ALHG5CY4EDFL0202	\$ 19.95	16.33	4/19/2021
95	PW heavy truck	2017	Ford	F550	Sign truck w auger	1FDUF5GT4HEB23386	\$ 19.95	16.33	6/25/2021
105	PW heavy Eq	2017	New Hollar	Ts6.130	Mower Tractor (Side mount)	NT01252M	\$ 19.95	\$ 16.33	9/1/2021
103	PW heavy Eq	2017	Massey Fer	5713SL	Mower Tractor (Side mount)	MV66DPHB040042	\$ 19.95	\$ 16.33	9/2/2021
102	PW heavy Eq	2020	New Hollar	TS6.120	Mower Tractor (Side mount)	NT02818M	\$ 19.95	\$ 16.33	9/24/2021
14-02	PW heavy Eq	2021	CAT	D3	Dozer		\$ 19.95	\$ 16.33	9/30/2021
14-03	PW heavy Eq	2021		D6	Dozer		\$ 19.95	\$ 16.33	10/21/2021
	PW heavy Eq	2021	Etyre		Chip Spreader		\$ 19.95	\$ 16.33	

Camera Purchase price: \$257.50

GPS Purchase price: \$62.50

Go Rugged for heavy equipment \$99.00

( pin connectors for big trucks \$28.06